

**Sandra Elgin**

**From:** Colin Smith [csmith@hg-group.co.uk]  
**Sent:** 25 April 2011 13:25  
**To:** 'Steven Bell'  
**Cc:** Donald McGougan; Sue Bruce (Chief Executive); 'vicemery'; 'Richard Jeffrey'; Alastair Maclean; 'Dennis Murray'; 'Alan Coyle'  
**Subject:** RE: MOV4:  
**Attachments:** Edinburgh Trams - Valuation Hg1-15Apr11.pdf

Details as requested  
 Regards  
 Colin

Colin Smith FRICS MAPM  
 Hg Consulting  
 Chartered Surveyors  
 70 Lymedoch Crescent  
 Glasgow  
 G3 6EQ

Tel: [REDACTED]  
 Email: [csmith@hg-group.co.uk](mailto:csmith@hg-group.co.uk)  
 Fax: [REDACTED]  
 Mobile [REDACTED]

 Please consider the environment before printing this email.

If you do need to print me then please recycle me afterwards, thank you! 

This e-mail message is confidential and for use by the addressee only. If the message is received by anyone other than the addressee, please return the message to the sender by replying to it and then delete the message from your computer. Internet e-mails are not necessarily secure. Hg Consulting does not accept responsibility for changes made to this message after it was sent. Whilst all reasonable care has been taken to avoid the transmission of viruses, it is the responsibility of the recipient to ensure that the onward transmission, opening or use of this message and any attachments will not adversely affect its systems or data. No responsibility is accepted by Hg Consulting in this regard and the recipient should carry out such virus and other checks as it considers appropriate. Hg Consulting (Scotland) Limited trading as Hg Consulting, registered in Scotland SC204303. Registered Address – 292 St Vincent Street, Glasgow, G2 5TQ

**From:** Steven Bell [mailto:Steven.Bell@tie.ltd.uk]  
**Sent:** 22 April 2011 18:34  
**To:** csmith@hg-group.co.uk  
**Cc:** Donald McGougan; Sue Bruce; vicemery; Richard Jeffrey; Alastair Maclean; Dennis Murray; Alan Coyle; Julie Smith; Julie Thompson  
**Subject:** RE: MOV4: Hg Certificate 1 etc.

11 at citypoint is good. See you then.

Steven

Sent from my Windows Mobile® phone.

26/04/2011

CEC02087179\_0001

**Edinburgh Tram Network  
Prioritised Works**

**Payment Application**

**Employer**

tie Limited

**Date :** 31-Mar-11

**Application Nr :** 1

**Main Contractor**

Bilfinger Berger Siemens Consortium

**as at :** 31-Mar-11

**Period End :** 42

APPLICATION			
	Current Cumulative	Previous Cumulative	Period
<b>Mobilisation / Others</b>			
BBUK	9,057,032.00		9,057,032.00
Siemens	5,407,212.00		5,407,212.00
<b>Materials and Equipment</b>			
Siemens	14,595,988.00		14,595,988.00
<b>Total</b>	<b>29,060,232.00</b>	<b>0.00</b>	<b>29,060,232.00</b>



# INVOICE



From : Bilfinger Berger Civil UK Limited  
BSC Consortium Office  
9 Lochside Avenue  
Edinburgh Park  
Edinburgh Park  
EH12 9DJ  
United Kingdom

Invoice Number : 25.1.201.00/58

Invoice Date : 15 April 2011

Period End : 31 March 2011

Application No : PW 1

Phone : + [REDACTED]  
Fax : +44 [REDACTED]

To : **the** Limited  
City Point  
65 Haymarket Terrace  
Edinburgh  
EH12 5HS

Due Date : 22 April 2011

For the attention of the Accounts Department

## Contract : Edinburgh Tram Network

Invoice Details :	Cumulative Amount Due	107,860,430.40
	Previously Invoiced Amount	(100,360,430.40)
	This Invoice Amount	7,500,000.00
	Value Added Tax at 20%	1,500,000.00
	Total Amount Due	9,000,000.00

Please pay the amount above directly to the following bank account

Account Name : [REDACTED]  
Account Number : [REDACTED]  
Sort Code : [REDACTED]  
Bank Name : [REDACTED]  
Bank Address : [REDACTED]  
SWIFT Code : [REDACTED]  
IBAN : [REDACTED]

VAT Registration Nr : [REDACTED]

# SIEMENS

## Industry Invoice

### Mobility - Turnkey Systems

Tie Limited  
CityPoint  
65 Haymarket Terrace  
Edinburgh  
Midlothian  
EH12 5HD

Please quote these details with the remittance

Invoice no. 1020121320 Customer no. 8339439

Date of invoice 15.04.2011 Currency GBP

Customer VAT no. GB790906049

Sales order no. 852246134 Dated 05.09.2003

Terms of payment 30 days from document date

Payment due date 15.05.2011

Your reference  
Infraco Contract

Our reference  
70PO-00170

Delivery address  
Tie Limited  
CityPoint  
65 Haymarket Terrace  
Edinburgh  
Midlothian EH12 5HD

Contact person(s)  
Neil Hibbert

Tel: [REDACTED] Fax: +44 121 7134370 Email: neil.hibbert@siemens.com

Item	Description of goods / services	Origin	Quantity/ Unit	Unit price	VAT	Total value
001000	GBX:SO-ZJSD Edinburgh Tram (TK Works) Certificate HG 1 Dated 15042011 AL: N, ECCN: N Harmonized System code: 85301000	GB	1 PC	91,144,637.82		17,492,208.44
						£19,500,000.00
002000	GBX:SO-ZJSD Edinburgh Tram (MT Works) AL: N, ECCN: N Harmonized System code: 85301000	GB	1 PC	5,906,945.47		1,133,643.46
003000	GBX:SO-ZJSD Edinburgh Tram (C&I Works) AL: N, ECCN: N Harmonized System code: 85301000	GB	1 PC	1,481,707.77		860,116.06
004000	GBX:SO-ZJSD Change Order 184 AL: N, ECCN: N Harmonized System code: 85301000	GB	1 PC	73,116.22		14,032.05
	<b>Total</b>					19,500,000.00
	VAT 20.00 % on 19,600,000.00				3,900,000.00	
	<b>Total amount Incl. VAT (GBP)</b>					<b>23,400,000.00</b>

7018ZCMB (Y1W)

Page 1/2

Mobility - Turnkey Systems  
A division of Siemens plc  
Registered No. 727817, England

Factory House  
311 William Siemens Square  
Frimley, Camberley  
GU16 6QO  
Tel: +44 1276 896000  
Fax: +44 1276 893133

Registered Office:  
Factory House  
31 William Siemens Square  
Frimley, Camberley, GU16 6QO  
VAT No. GB 479 8652 65

Chèques & Remittance Advices to:  
Siemens PLC  
ASF Credit Services  
31 William Siemens Square  
Frimley Road  
Mereheaton, M20 2UR  
Fax No: 0845 605 3977  
ev:sl: Bankadmin.in@siemens.com



# SIEMENS

## Invoice

Tie Limited  
CityPoint  
65 Haymarket Terrace  
Edinburgh  
Midlothian  
EH12 5HD

Please quote these details with the remittance

Invoice no.

Customer no.

Date of Invoice  
15.04.2011

Currency  
GBP

Item	Description of goods / services	Origin	Quantity/ Unit	Unit price	VAT	Total value
------	---------------------------------	--------	-------------------	------------	-----	-------------

**Credit Transfer to**

Bank details:

A/c no:

Sort code:

Swift Code:

IBAN:

Bank:

For payment queries please contact:

LYNN RYAN

Tel:

Fax:

Email: LYNN.RYAN@SIEMENS.COM

Goods coded with "AL not equal to N" are subject to European or National export authorisation when being exported outside of the EU. Goods coded with "ECCN not equal to N" are subject to US re-export authorisation. Even without any code, or with code "AL:N" or "ECCN:N" export licences may be required due to the end user and / or end use of the goods.

7019Z0MB (YWA)

Mobility - Turnkey Systems  
A division of Siemens plc  
Registered No 727077, England

Fareway House  
St William Square  
Fareley, Camberley

Registered Office:  
Fareway House  
St William Square

Cheques & Remittance Advices to:  
Siemens PLC  
ASP Credit Services

Page 2 / 2

CEC02087179\_0005

## Independent Certifier's Certificate for Payment No. 1

Project Name:	Edinburgh Trams		
Recipient:	Bilfinger Berger Siemens		
Certificate No:	One	Project Monitor:	Hg Consulting
<b>Payment Application information from Recipient:</b>			
Amount of instalment applied for by Recipient		£27,000,000.00	
Application received by Hg Consulting on (date):		8 <sup>th</sup> April 2011	

<b>Verification by Project Monitor:</b>		<b>Signed by Project Monitor</b>	
Is the payment application:			
• complete and was it prepared by the Recipient?	YES		
• consistent with Minute of Variation No. 4?	YES		
Has the application and support data been checked?	YES		
Has a site visit been made to verify the works?	NO		
This payment application is for:			
<b>A MILESTONE payment application only, milestone achievement record:</b>			
	Milestone No.	Date of achievement (as certified by Project Monitor)	Cumulative value to date (exclusive of VAT)
Previously Certified	Nil	N/A	
New Certified	£27,000,000.00	15 <sup>th</sup> April 2011	£27,000,000.00

Date due for Payment	22 <sup>nd</sup> April 2011
----------------------	-----------------------------

Certified by Project Monitor (signed):		Date:	15 <sup>th</sup> April 2011
--	---	-------	-----------------------------

Recipient   
  CEC   
  tlc   
  Project Monitor   
  File

**Monthly Progress Report Summary**

Project Name:	Edinburgh Trams		
Recipient:	Bilfinger Berger Siemens		
Report to [date]:	8 <sup>th</sup> April 2011	Project Monitor:	Hg Consulting

<b>Summary of progress statistics:</b>		
Implementation start date:	(as defined in Baseline Progress Report No. 1)	8 <sup>th</sup> April 2011
Forecast duration in weeks:	(as defined in Baseline Progress Report No. 1)	
Time elapsed since start:	(calendar weeks)	1 week
Project Monitor's assessment of progress achieved	(weeks) (ignoring changes to Baseline)	1 week
Progress variance against programme:	(weeks)	Nil
Cost Forecast:	(as defined in Baseline Progress Report No. 1)	

<b>Comments by Project Monitor</b>	
General overview:	As reported in Baseline Progress Report No. 1
Project management:	As reported in Baseline Progress Report No. 1
Main areas of concern/cause of problem(s)/implications:	As reported in Baseline Progress Report No. 1
Risk appraisal review (where applicable):	As reported in Baseline Progress Report No. 1
Proposed solution(s)/responsible person/date to be actioned by:	As reported in Baseline Progress Report No. 1
Potential future problems/solutions:	As reported in Baseline Progress Report No. 1
Successes/achievements in month:	As reported in Baseline Progress Report No. 1
Operational start up:	4 <sup>th</sup> April 2011
Signed by Project Monitor:	 Date: 15 <sup>th</sup> April 2011

**Edinburgh Tram Network**  
**Certificate Hg 1 as it relates to Bilfinger Berger Civil UK Limited**

**Statement of Design Stage**

We have attached the Design Progress Table at Appendix B which illustrates the progress of the Design from 15 March 2011 to 07 April 2011.

Significant Progress has been made up to 07 April 2011 including the close out of 99% of CEC Technical "Open" comments, 87% of "Critical" Comments and 67% of Technical Informatives. Although progress on Planning Issues looks minimal, CEC Planning have been "brought" along with this design close out process, so that the sign off of Planning Informatives and Variations will be a formality rather than further design iterations.

SDS has increased resources (Designers and CAD Technicians) to progress the outstanding design works. Infraco, SDS and CEC committed to 7 day working between 15 March 2011 and 10 April 2011 to increase outputs and achieve the progress demonstrated within the table in Appendix A.

The key areas to be addressed in the immediate future are outlined below

1. Completion and Approval of Trackform design (Infraco / CEC)
2. Instructions for new design changes or confirmation on scope (tie / CEC)
  - Gogar Castle Access Road
  - Depot Access Road Turning Head
  - Additional Cycle path at Lindsay Road – Hawthornvale
  - Roseburn Viaduct (scope confirmation)
  - Cathedral Lane Substation (scope confirmation)
  - New Footpath at Ocean Drive
  - Incorporate new design for Ocean Terminal Bypass Road
  - Confirmation of no lettering / signage on top of tram stop shelters
  - Design of Temporary Overhead Catenary System for "Mini Test Track"
3. Decision on Edinburgh Gateway Retaining Wall Design Option (tie)
4. Close out of Traffic Modelling (Infraco / CEC)
5. Close out of remaining core scope Technical and Planning Approvals (Infraco)
6. Decision on exact scope of York Place Terminal Point (CEC)
7. Infraco to progress number of design changes including
  - Depot Access Road Turning Head
  - Gogar Castle Access Road
  - Picardy Place
  - Roseburn Viaduct
  - Airport Canopy /Kiosk

## **Evaluation of Design**

Using our Project Phoenix Proposal, as a basis, we have assessed that to date the amount due for Design is approx £1.80 million (refer Appendix C) and should be included in the Hg 1 Certificate to reflect the progress achieved to date.

A further expenditure of £1.75 million is anticipated for the completion of the Design and this is spread over the next four months, notwithstanding the fact that it was indicated by the fact that they would be amenable to certifying the remaining amount due for Design in one single period on completion of the Design, namely April 2011.

There will also be a requirement in the future to expend cost for Design and Extended Construction Support.

## **Orders / Instructions to Suppliers / Subcontractors**

We have agreed Heads of Terms with Barr Limited regarding the Depot and associated works including the Mini Test Track which allowed Barr Ltd to restart in this area on the 4 April 2011. A copy of the redacted Heads of Terms is attached at Appendix B. We are working to finalise a Minute of Variation to Barr Ltd's Subcontract to reflect the agreements made and the revised dates for completion in line with the current Prioritised Works Programme.

We have instructed Farrans Ltd to proceed with the Site Clearance works in Section 7A as per the attached Site Instruction No 58 dated 18 March 2011. (Appendix C)

In respect of Haymarket Yards we have set in motion a procurement process which will allow us to start in the Haymarket Yards area on the 3 May 2011. This process involves discussing with our current Section 2A subcontractor, John Graham (Dromore) Ltd, their availability and ability to carry out this work this section of works.

Given the limited scope of the prioritised works in Haymarket Yards it may not make economic sense for Grahams to carry out this work, therefore we are, in parallel, seeking alternative quotations for this work from other smaller subcontractors as a stand alone package.

We are discussing with Expanded Ltd the potential, that subject to agreement of the Minute of Variation relating to the Prioritised Works for them to restart works at the A8 Underpass.

We are also progressing the preparation of enquiry documents for the On Street Works which will be done under the Target Price arrangement.

We have assessed the cost of this procurement exercise to the 31 March 2011 at approx £100,000.

## Depot

As we have already mentioned we have remobilised in the Depot.

Prior to the Mediation talks in March we were having productive discussions with tie in an effort to reach agreement on Changed works which had already been completed in the Depot and to seek agreement on the remaining areas of work in the Depot where Change was preventing progress.

With reference to our Project Phoenix Proposal, and in particular Appendix 1.1 (Page 12) we have identified that the amount outstanding on the Barr Limited account for work executed up to the 28 February 2011 against the certification by tie in Construction Interim Certificate 41 was approx £5.5 million (Refer Appendix F).

We consider that the certification of this outstanding amount is key to the achievement of the planned Section A completion date.

### Other Change Completed and Not yet Certified

Across many areas of the site we have executed Change in advance of agreeing a tie Change Order where it is clear that the works have changed and that there has been in part an acknowledgement by tie that a Change has occurred.

Despite this acknowledgement there remains a significant amount outstanding where the works have already been executed.

Attached at Appendix G we highlight a series of Changes where the current difference between what has been applied and certified at the 31 March 2011 is greater than £70,000.

The total amount outstanding in respect of these items is approx £1.6 million.

Edinburgh Tram Network  
Issue to be covered by Hg 1 Valuation Certificate  
Prioritised Civil Works

Appendix A

Item	Description	Amount
1	Design	1,801,648
2	Depot Mobilisation	5,531,930
3	Other Change Completed and not Certified	1,629,704
4	Procurement of Prioritised Works	93,750
<b>Total</b>		<b>9,057,032</b>



**Appendix B: Design Progress Table**

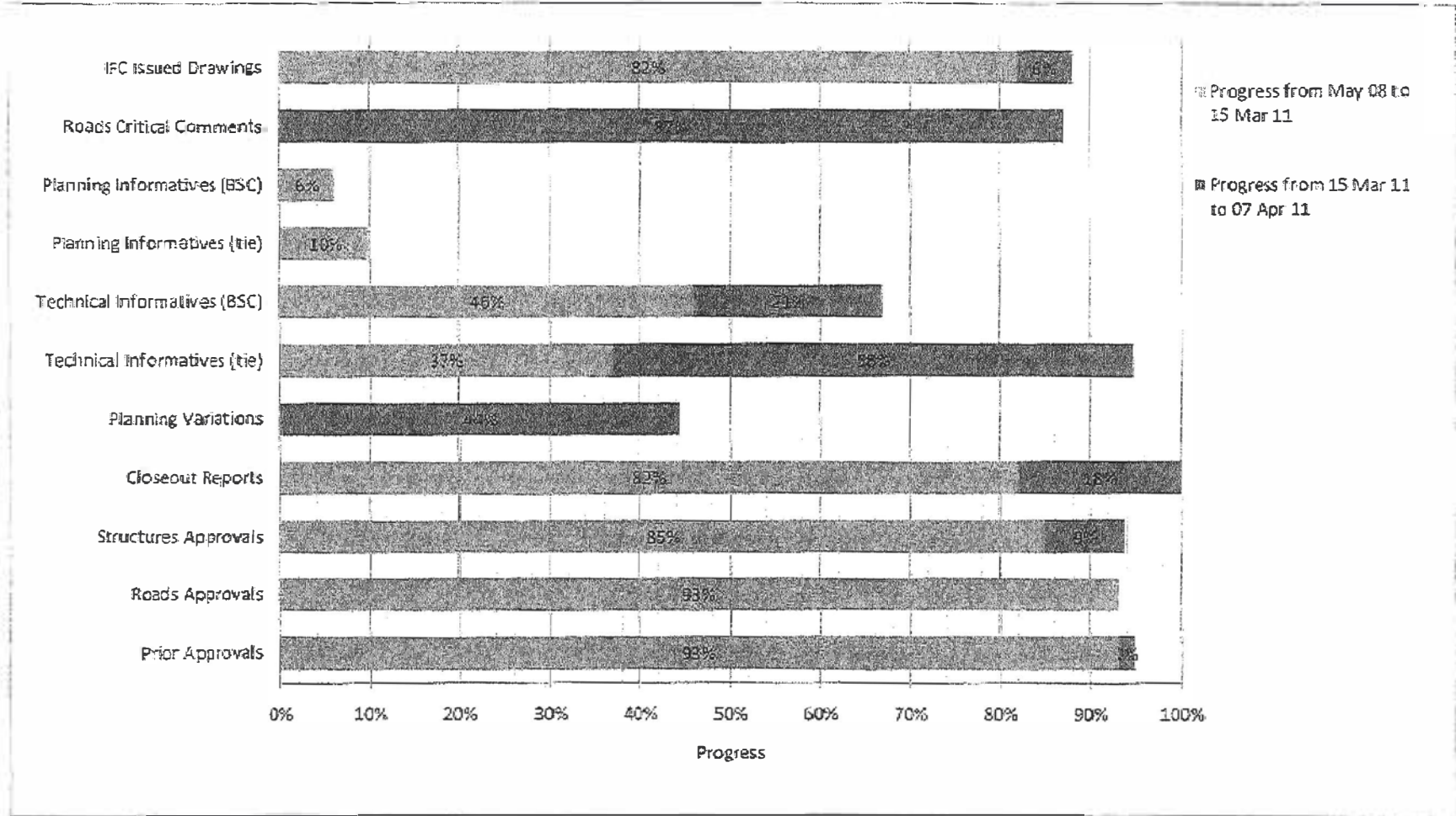



SDS - Project Phoenix Proposal Pricing Summary

SDS ref:	Type			Fee to Complete	Certified to Date (1)	Overall Fee
ULE90390A	Core Scope			£ 220,013	£ 1,984,779	£ 2,204,792
ULE90390A	Changes			£ 1,424,875	£ 2,810,073	£ 4,234,948
ULE90485A	DC - Design Coordination			£ 70,714	£ 424,266	£ 495,000
ULE90391A	Phase IV			£ 378,453	£ 848,860	£ 1,227,313
ULE90393A	DS - Design Support			£ 186,308	£ 857,956	£ 1,044,268
ULE90392A	ECS - Extended Construction Support			£ 1,859,021	£ 2,062,068	£ 3,921,089
ULE90392A	ATR			£ 150,000	£ 205,795	£ 355,795
ULE90390A	Disruption			£ 500,000	£	£ 500,000
ULE90474A	Prolongation			£ 957,593	£ 200,000	£ 1,157,593
ULE90390A	Incentivisation (2)					

<b>Total</b>	£ 5,746,977	£ 9,395,816	£ 15,140,795
--------------	-------------	-------------	--------------

Remaining Fee to Complete after deduction of Design and Extended Construction Support and ATRs

£ 3,551,648
-------------

Design Completed to 31 March 2011

£ 1,301,646	included as part of Mobilisation
-------------	----------------------------------

Future Design to Complete by the end of April 2011

£ 1,750,000	spread over 4 months in Schedule Part 2
-------------	---

ECS for Prioritised Works period (75k \* 4 months and 100k \* 2 months)

£ 450,000	spread over 4 months in Schedule Part 3
-----------	---

**Edinburgh Tram Network  
Future Working Arrangements**

**Heads of Terms: 2<sup>nd</sup> April 2011**

**Barr Limited**

**1. Agreed Price**

The Lump Sum is agreed in the amount of [REDACTED] as Full and Final Settlement of all matters and issues relating to this sub-contract .

**2. Programme**

The agreed Target Programme is completion of the Sub-contract works by the 16<sup>th</sup> July 2011, including all works associated with the water main, subject to a decision being made to change the water main on or before 8<sup>th</sup> April 2011.

**3. Liquidated and Ascertained Damages (LAD's)**

It is agreed that LAD's will apply from the [REDACTED] should Completion of the sub-contract works not be achieved.

**4. Water Main**

An agreed Provisional Sum of [REDACTED] is included with the Lump Sum. This is to be finalised on resolution of the water main design issue.

**5. Other Matters.**

1. ~~Full cooperation from Barr with all consortium partners, designers, sub-contractors at all times.~~

2. Full cooperation from Barr with all consortium partners, designers, sub-contractors at all times.

3. Issues which may prevent progress on site are required to be raised to Construction Manager level immediately for resolution.

WPS  
J.F.

4. Fortnightly joint meetings to be held with the Senior Management of BBCUK/Barr/Siemens to review progress and resolve any underlying issues which will prevent or delay completion.

5. Agreement of a Minute of Variation including the revised scope; the execution of the sub-contract including any collateral warranties, PCG's, etc to be concluded by 8<sup>th</sup> April 2011.

6. CEC/BBCUK require a show of activity on site on Monday 4<sup>th</sup> April 2011 to demonstrate the commitment to progressing the works. Details to be agreed.

7. Full mobilisation to recommence in accordance with the agreed programme will start on the 5<sup>th</sup> April 2011.

8. Design information needs to be released to allow the programme to be met.

Signed for and on Behalf of

Bilfinger Berger Civil UK Limited



Position: PROJECT DIRECTOR

Date: 02/04/2011

Signed for and on Behalf of

Barr Limited



Position: DIRECTOR

Date: 02/04/2011

*Handwritten signature*

Drawing ULR50130-05-TAL-00024 - Overmarked to show extent of Main Test Track

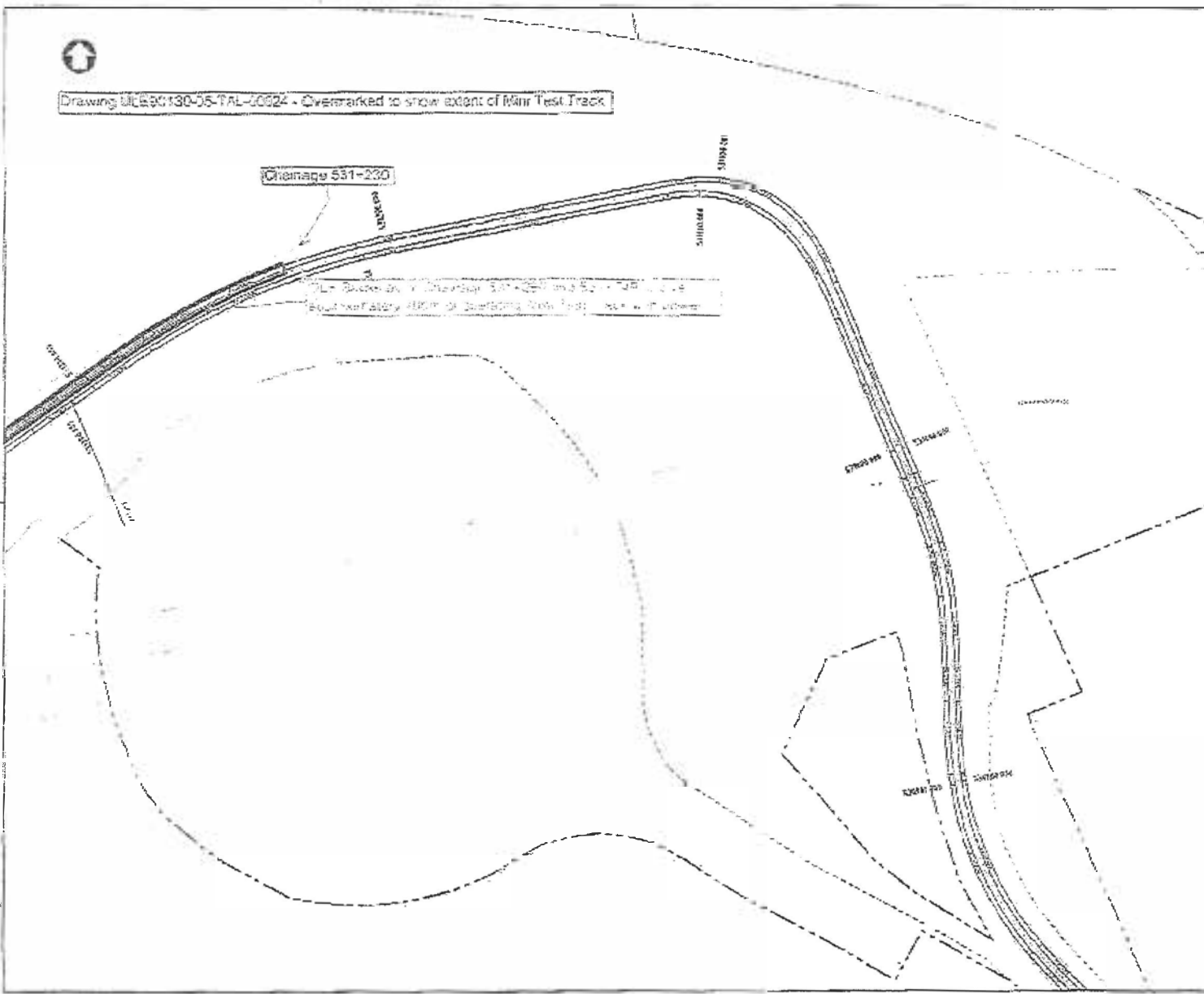

1973  
 01/13

**NOTES**

1. ALL DIMENSIONS ARE IN FEET AND DECIMALS THEREOF.
2. THE TRACK CENTERLINE IS LOCATED AT THE CENTER OF THE TRACK.
3. THE TRACK WIDTH IS 100 FEET.
4. THE TRACK IS TO BE CONSTRUCTED ON THE EXISTING GRADE.
5. THE TRACK IS TO BE CONSTRUCTED ON THE EXISTING GRADE.
6. THE TRACK IS TO BE CONSTRUCTED ON THE EXISTING GRADE.
7. THE TRACK IS TO BE CONSTRUCTED ON THE EXISTING GRADE.
8. THE TRACK IS TO BE CONSTRUCTED ON THE EXISTING GRADE.
9. THE TRACK IS TO BE CONSTRUCTED ON THE EXISTING GRADE.
10. THE TRACK IS TO BE CONSTRUCTED ON THE EXISTING GRADE.

**KEY**

1. TRACK CENTERLINE  
 2. TRACK WIDTH  
 3. TRACK GRADE  
 4. TRACK ALIGNMENT

**LEGEND**

1. TRACK CENTERLINE  
 2. TRACK WIDTH  
 3. TRACK GRADE  
 4. TRACK ALIGNMENT

**REVISIONS**

NO.	DATE	DESCRIPTION
1	01/13/73	ISSUED FOR CONSTRUCTION

**ISSUED FOR CONSTRUCTION**

**DESIGNER**  
 [Signature]

**CHECKED**  
 [Signature]

**APPROVED**  
 [Signature]

**SCALE**  
 1" = 100'

**PROJECT**  
 MID-SOUTH RAILROAD TRACK RECONSTRUCTION  
 SHEET 05 OF 24  
 (SEE SECTION 04)

**DATE**  
 01/13/73

**DRAWN**  
 [Signature]

**CHECKED**  
 [Signature]

**APPROVED**  
 [Signature]

**SCALE**  
 1" = 100'

**PROJECT**  
 MID-SOUTH RAILROAD TRACK RECONSTRUCTION  
 SHEET 05 OF 24  
 (SEE SECTION 04)

**DATE**  
 01/13/73

**DRAWN**  
 [Signature]

**CHECKED**  
 [Signature]

**APPROVED**  
 [Signature]



Drawing ULE90430-08-DEP-00013 - Overmarked to show extent of Mini Trestle

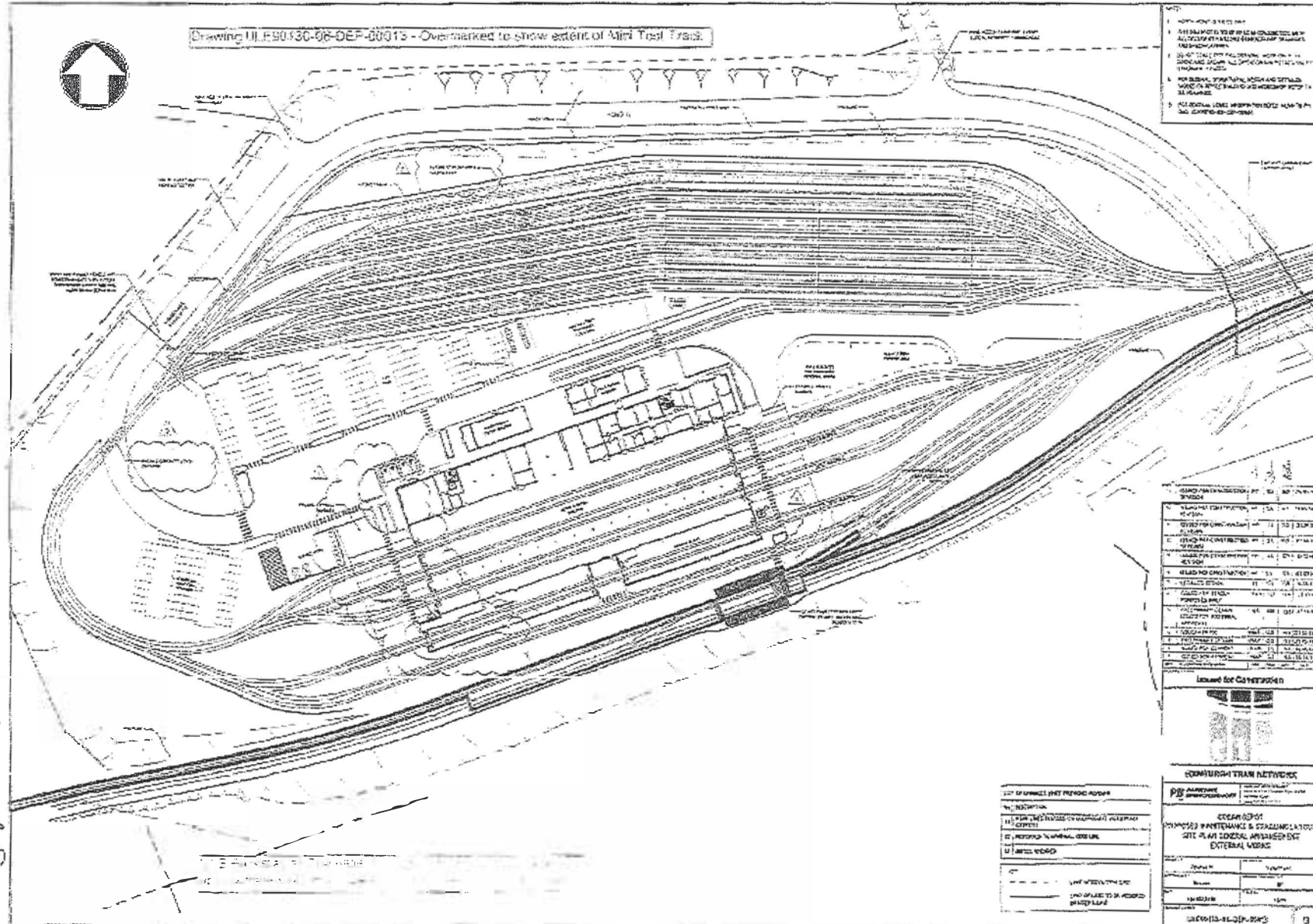

1. NOT TO SCALE
2. ALL DIMENSIONS TO BE IN METERS UNLESS OTHERWISE SPECIFIED
3. ALL DIMENSIONS TO BE IN METERS UNLESS OTHERWISE SPECIFIED
4. ALL DIMENSIONS TO BE IN METERS UNLESS OTHERWISE SPECIFIED
5. ALL DIMENSIONS TO BE IN METERS UNLESS OTHERWISE SPECIFIED

10/25  
01/17

NO.	DESCRIPTION	QTY	UNIT	AMOUNT
1	CONCRETE	150	m <sup>3</sup>	150
2	STEEL	100	kg	100
3	BRICK	500	m <sup>2</sup>	500
4	GLASS	200	m <sup>2</sup>	200
5	PAINT	100	kg	100
6	WATER	1000	m <sup>3</sup>	1000
7	ELECTRICITY	1000	kWh	1000
8	HEATING	1000	kWh	1000
9	CLEANING	1000	kg	1000
10	MAINTENANCE	1000	hr	1000



NO.	DESCRIPTION	QTY	UNIT	AMOUNT
1	CONCRETE	150	m <sup>3</sup>	150
2	STEEL	100	kg	100
3	BRICK	500	m <sup>2</sup>	500
4	GLASS	200	m <sup>2</sup>	200
5	PAINT	100	kg	100
6	WATER	1000	m <sup>3</sup>	1000
7	ELECTRICITY	1000	kWh	1000
8	HEATING	1000	kWh	1000
9	CLEANING	1000	kg	1000
10	MAINTENANCE	1000	hr	1000

NO.	DESCRIPTION	QTY	UNIT	AMOUNT
1	CONCRETE	150	m <sup>3</sup>	150
2	STEEL	100	kg	100
3	BRICK	500	m <sup>2</sup>	500
4	GLASS	200	m <sup>2</sup>	200
5	PAINT	100	kg	100
6	WATER	1000	m <sup>3</sup>	1000
7	ELECTRICITY	1000	kWh	1000
8	HEATING	1000	kWh	1000
9	CLEANING	1000	kg	1000
10	MAINTENANCE	1000	hr	1000







	<h2>Site Instruction</h2>	Form: F74-7 Rev: B Page: 1 of 1
---	---------------------------	---------------------------------------

Project: Edinburgh Tram Network	SI Ref: 58
Section: 7A	Date: 18/03/2011
Section Manager: Alastair Scott	Subcontractor: Farrans
Design Package:	Designer: SDS

**Basils / Source of Request:**

Please carry out the works as described below. This instruction is issued to you in accordance with the terms and conditions of your subcontract.

**Removal of Trees in W14C area before start of Nesting Season**

Please carry out the removal of all trees required as part of the site clearance for Retaining Wall W14C.

This Site Instruction carries no additional value to the Contract Price for these works.

For payment purposes, part payment of the milestone is agreed to the value of the Subcontract Works plus 9.5% uplift on completion and supply of invoice.

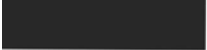
Signed:  Date: 18/3/11 Name: *D. Hayes*  
 Signed:  Date: 18/3/11 Name: A. SCOTT

(for and on behalf of Bilfinger Berger UK Limited)

Internal Distribution	External Distribution
DGo JDo ASc CGe	PM NMCD CMcC



Edinburgh Tram Network  
 Project Phoenix Proposal: Price  
 Subcontractor PPP Price Summary  
 Subcontractor: Barr Ltd

Appendix F  
 15 April 2011

Section 5 : Depot

Item	Description	Original SubContract Value	GRAND TOTAL										Liability to J2M Feb 2011	Certified to 28 Feb 2011 (OC-41)	Work in Progress
			Process and Method Related Changes		Construction Works				Construction Value Total	Net / Contractor	Grand Total				
			10 24 Month 2011	2a Corrosion	Original Subcontract Work	Change									
					Already Subcontracted and Agreed	At early submission and Not Agreed	New Substitution								
1	Prequisites & General Item	2,337,178	2,337,178	2,337,178								2,337,178	2,337,178		
2	Method Related Changes														
3	Earthworks	92,200			92,000	48,843	309,625	1,411	207,670			207,670	152,625		
4	Sub-structure - Depot Building	1,116,480			1,118,433	90,385	95,051	7,579	1,209,468			1,209,468	1,312,043		
5	Sub-structure - Sub Station Building	57,883			57,883	-	-	25,351	73,234			73,234	114,638		
6	Sub-structure - Power Building	51,216			51,155	-	-	728	55,883			55,883			
7	Frame	1,180,318			1,160,208	276,298	177,332	287	1,674,100			1,674,100	1,628,530		
8	Upper Floors	102,661			102,651	-	-	-	102,651			102,651	114,451		
9	Cladding	1,204,540			1,228,620	78,790	41,944	1,875	1,329,268			1,329,268	1,781,149		
10	Stair	6,800			6,800	-	27,403	-	30,203			30,203			
11	External Glazework	288,400			287,800	36,429	75,000	-	300,029			300,029	156,609		
12	Warmthall and Passages	261,088			261,088	-	17,509	1,522	280,119			280,119	262,167		
13	Internal Doors	164,900			164,900	-	29,968	6,659	182,527			182,527	178,278		
14	Wall Finishes	117,716			117,716	-	5,000	-	122,716			122,716	132,985		
15	Floor Finishes	202,207			202,207	-	8,951	-	211,158			211,158	79,445		
16	Carriage Platforms	60,210			60,210	-	8,210	-	68,420			68,420	94,251		
17	Glazework	38,026			38,026	-	-	-	38,026			38,026	34,136		
18	Glazing and Fix Hardware	62,143			62,143	-	18,185	3,657	84,064			84,064	61,132		
19	M&E	2,202,560			2,202,000	22,560	97,808	152,489	2,634,801			2,634,801	2,207,863		
20	SWK Services	25,000			25,000	-	-	-	25,000			25,000			
21	Site Work	2,860,602			2,860,602	554,405	2,097,107	3,270	4,557,684			4,557,684	2,291,238		
22	Sub Station Building	123,555			123,095	-	-	-	123,095			123,095	754,167		
23	Power Building	109,846			109,846	-	650	-	110,496			110,496	763		
24	Scordas	282,545			232,555	-	32,448	2,045	256,858	311,000		569,858	64,293		
25	Transfer from Risk Register							182,750	182,750			182,750			
	<b>Total</b>	<b>12,000,000</b>	<b>12,000,000</b>	<b>12,000,000</b>	<b>12,000,000</b>	<b>1,000,000</b>	<b>1,000,000</b>	<b>1,000,000</b>	<b>12,000,000</b>	<b>311,000</b>	<b>12,311,000</b>	<b>12,311,000</b>	<b>12,311,000</b>	<b>7,511,000</b>	<b>5,500,000</b>

\* All the 20th January 2011

Edinburgh Train Network  
2001 Civil Construction Milestones and Change Certified as of 31 March 2011

Period No.	Work done to date	Application No.	Railway	Location	Description	W/C Discipline	Project	Actual Value of Work Done	Applied £	Certified £	Outstanding
21	07/11/2009	24	A17170	Depot Building	Foundations - Column Foundations	Depot Structure	6	127110000	185,376.33	185,376.33	
21	07/11/2009	24	A17160C	Depot Building	Substructure and Superstructure Primary G. & 10-1	Depot Structure	6	277110000	185,376.33	185,376.33	
21	07/11/2009	24	A17160C	Depot Building	Substructure and Superstructure Secondary G. & 10-1	Depot Structure	6	277110000	185,376.33	185,376.33	
22	07/11/2009	25	A17185	Depot Building	Superstructure & Substructure - Primary GLE 20-10	Depot Structure	6	277110000	185,376.33	185,376.33	
22	07/11/2009	25	A17185	Depot Building	Substructure & Superstructure - Secondary GLE 20-11	Depot Structure	6	277110000	185,376.33	185,376.33	
22	07/11/2009	25	A17200	Depot Building	Substructure & Superstructure - Ground Floor Slab GLE 20-10	Depot Structure	6	041220000	185,376.33	185,376.33	
24	20/01/2010	27	A17200	Depot Building	Substructure & Superstructure - Roof Slabbing	Depot Structure	6	140120000	185,376.33	185,376.33	
24	20/01/2010	27	A17200	Depot Building	Substructure and Superstructure - Ground Floor Slab GLE 10-1	Depot Structure	6	250220000	185,376.33	185,376.33	
25	27/02/2010	28	A17200	Depot Building	Primary GLE 10-1	Depot Structure	6	250220000	185,376.33	185,376.33	
25	27/02/2010	28	A17200	Depot Building	Service Trough GLE 10-1	Depot Structure	6	250220000	185,376.33	185,376.33	
25	27/02/2010	28	A17200	Depot Building	Service Trough GLE 10-1	Depot Structure	6	250220000	185,376.33	185,376.33	
26	27/02/2010	28	A17200	Depot Building	Foundations - Ground Beams	Depot Structure	6	250220000	185,376.33	185,376.33	
27	24/04/2010	30	A17200	Depot Building	Substructure & Superstructure - Drainage GLE 20-10	Depot Structure	6	250220000	185,376.33	185,376.33	
27	24/04/2010	30	1178	Depot Building	North Side - Drainage & Drainage	Depot Structure	6	040400000	178,552.47	178,552.47	
27	24/04/2010	30	A17200	Depot Building	Service Trough GLE 20-10	Depot Structure	6	250220000	185,376.33	185,376.33	
27	24/04/2010	30	A17210	Depot Building	Outer Depot Gas Structure - Drainage	Depot Structure	6	250220000	185,376.33	185,376.33	
28	22/05/2010	31	A17200	Depot Building	Substructure & Superstructure - GLE 10-1	Depot Structure	6	140220000	185,376.33	185,376.33	
28	22/05/2010	31	A17200	Depot Building	Substructure & Superstructure - GLE 20-10	Depot Structure	6	140220000	185,376.33	185,376.33	
28	22/05/2010	31	A17210	Depot Building	Building Envelope - Translucent Panels	Depot Structure	6	040500000	185,376.33	185,376.33	
28	22/05/2010	31	A17170	Depot Building	Foundations - GLE Foundations	Depot Structure	6	140220000	185,376.33	185,376.33	
29	18/06/2010	32	A17170	Depot Building	Pile - Flight 200	Depot Structure	6	140220000	185,376.33	185,376.33	
29	18/06/2010	32	A17170	Depot Building	Pile - Wheel Lath	Depot Structure	6	170720000	185,376.33	185,376.33	
30	18/06/2010	32	A17110	Depot Building	Building Envelope - Curtain Walling	Depot Structure	6	170720000	185,376.33	185,376.33	
31	14/08/2010	34	A17210	Depot Building	Building Envelope - Blockwork	Depot Structure	6	120620000	185,376.33	185,376.33	
31	14/08/2010	34	A17210	Depot Building	Building Envelope - Wall Cladding	Depot Structure	6	120620000	185,376.33	185,376.33	
31	14/08/2010	34	A17100	Depot Building	Pile - Inceptor	Depot Structure	6	120620000	185,376.33	185,376.33	
31	14/08/2010	34	1219	Depot Building	Track & Shunting Area - GLE Foundations	Depot Structure	6	120620000	77,524.12	77,524.12	
32	11/09/2010	35	A17200	Depot Building	Substructure and Superstructure - Ground Floor Slab GLE 20-10	Depot Structure	6	041220000	185,376.33	185,376.33	
32	11/09/2010	35	A17200	Depot Building	Substructure and Superstructure - Substructure GLE 20-10	Depot Structure	6	041220000	185,376.33	185,376.33	
34	05/11/2010	37	310	Depot Building	Civil Engineering and Building Works - West End	Structure	6	061120000	147,960.66	147,960.66	
34	05/11/2010	37	A17210	Depot Building	Building Envelope - Lowrise	Structure	6	061120000	147,960.66	147,960.66	
33	25/03/2011	41	1259	Depot Building	Piling and Soil Nails - Ground Floor	Structure	6	011320000	185,376.33	185,376.33	
33	25/03/2011	41	A17210	Depot Building	Building Envelope - 5th Deck	Structure	6	011320000	185,376.33	185,376.33	
23	07/11/2009	24	1149	Outer Earthworks	Earthworks Depot - Depot Area	Earth Structure	6	071120000	185,376.33	185,376.33	
24	20/01/2010	27	1148	Outer Earthworks	Carriageway	Earth Structure	6	250120000	185,376.33	185,376.33	
30	17/07/2010	33	1148	Outer Earthworks	Earthworks Depot - Shunting Area	Earth Structure	6	170720000	185,376.33	185,376.33	
21	07/11/2009	24	1150	Depot Procurement	Systems Procurement	Structure	6	071120000	185,376.33	185,376.33	
31	09/10/2010	38	310	Depot Substation	Civil Engineering and Building Works - Plant & Equipment	Structure	6	061120000	73,840.52	73,840.52	
30	09/10/2010	36	310	Depot Substation	Civil Engineering and Building Works - Service Connections	Structure	6	061120000	24,660.11	24,660.11	
32	17/07/2010	33	154	Depot Trackwork	Trackwork Depot	Track	6	170720000	62,977.60	62,977.60	
34	05/11/2010	37	154	Depot Trackwork	Depot Trackwork - Zone 2	Track	6	201020000	62,977.60	62,977.60	
34	05/11/2010	37	154	Depot Trackwork	Depot Trackwork - Zone 4	Track	6	201020000	62,977.60	62,977.60	
35	04/11/2010	38	1209	Signal Depot	Depot Trackwork - Piling GLE & Foundations - East Floor	Earth Structure	6	201120000	185,376.33	185,376.33	
35	04/11/2010	38	1209	Signal Depot	Signal Depot	Earth Structure	6	201120000	2,482.92	2,482.92	
28	22/05/2010	31	1209	Signal Depot Access Passes	Carpet and Acoustics - Signal Water Drainage	Highways	6	190520000	124,198.59	124,198.59	
								7,481,811.10	6,893,322.40	6,917,717.49	

From Change Application in respect of the Depot

2,082,486.12 555,786.01 1,526,711.11

Total as of 31 March 2011 for Depot Works relating to EPR Ltd

8,274,411.28 7,251,301.41 7,444,428.60



Edinburgh Tram Network  
 Completed Depot Change Issues not Certified and not Subject to formal Dispute as at 31 March 2011

BSC ref (INTC Nr)	ECO Ref	Description	Section	Applied	Certified	Variance
88a	137	Power Supply ducts section 0	6	13,297	13,297	(0)
203a	78	Foundations	6	47,782	47,782	(0)
203b	78	Structural Steelwork	6	270,328	270,328	0
203h1		Drainage BDDI to IFC Change	6	(12,370)	(115,849)	(103,479)
203h2		Drainage including Depot Pumping Station, manhole and rising man	6	144,505	185,356	50,850
203j	114	BDDI to IFC changes to depot access rd	6	78,675	78,675	(0)
203k1		Piling to OLE Poles - IFC Drawings	6	285,528		(285,528)
203k2		Increase in number of OLE bases	6	48,472		(48,472)
203l		IFC issue drawings for reinforcement to pit walls	6	57,059		(57,059)
203o		IFC issue drawings for introduction of waterproof concrete	6	76,076		(76,076)
203m		IFC issue drawings for installation of incoming gas man	6	97,473		(97,473)
203N		Increase in size of attenuation tank	6	86,118		(86,118)
203p	140	IFC issue drawings for alteration to Scottish Water valves - MUDFA works	6	5,368	5,368	0
203q		IFC issue drawings for earthing and bonding	6	78,856		(78,856)
203s		IFC drawing changes - revised spec Kaba Doors	6	152,505		(152,505)
203t		IFC drawing change - to sub station slab	6	27,976		(27,976)
203u2		IFC issue drawings for Internal Fire Doors	6	24,268		(24,268)
203v		IFC drawing change to drainage rev B	6	153,955	26,022	(127,933)
203w		IFC Drawing change to blockwork / reinforcement	6	135,992		(135,992)
203x		Wind Posts to Block Work	6	23,430		(23,430)
203z		Structural Steelwork to Support Sliding screens to offices	6	6,850		(6,850)
203AA		BDDI - IFC Tram Wash Plinth Change	6	6,935		(6,935)
203AC		BDDI - IFC Suspended Ceiling in Battery Room Change	6	1,631		(1,631)
203AF		Maintenance Pits Steel Plinths	6	69,565		(69,565)
203AG		Change to Depot Service Yard	6	48,704		(48,704)
203AH		Acc Drainage Channels to Hard Standing	6	18,006		(18,006)
203AJ		BDDI to IFC Changes to Roof / rail crossing	6	2,571		(2,571)
203AS		BDDI to IFC Depot Building Rheda City C Trackform Change	6	31,385		(31,385)
320		Introduction of mass concrete foundations at Depot	6	30,815		(30,815)
407	97	Hard material within Goopar excavation	6	35,807	35,807	0
423		Remove Soft Material from Sub Grade of Depot Access Road as per CVI BARR06/007	6	36,804		(36,804)
		<b>Total</b>		<b>2,082,486</b>	<b>555,785</b>	<b>(1,526,701)</b>

Edinburgh Tram Network  
 Completed Change Issues not Certified and not Subject to formal Dispute as at 31 March 2011

Appendix G

BSC ref (INTC Nr)	ICO Ref	Description	Section	Applied	Certified	Variance
262b		IFC Drawing Changes - Section 5B - Track Drainage	5b	389,912	216,611	(173,301)
315		IFC Drawing Changes - Drainage - Gogarburn to Airport	7A	863,363	791,432	(71,931)
357		Trial Holes in Princes Street	1C	235,090	84,538	(150,552)
374b		Gogar Landfill Area surcharging and monitoring of surcharge	7A	458,002	179,618	(278,385)
399	141	Addition of starter and capping layers in Section 7A	5C	1,237,876	1,123,423	(114,455)
441a		Site Wide Contamination	SW	92,820		(92,820)
511		Russell Road Retaining Wall 4 - piling obstructions - alternative design required.	5A	389,613		(389,613)
523		AB Underpass - support and protect BT equipment	5C	80,348		(80,348)
551	169	Section 5A -- Removal and disposal of contaminated soil at Russell Road Retaining Wall	5A	542,946	397,000	(145,946)
584		Invasive species - Gogar Landfill - Giant Hogweed	7A	132,335		(132,335)
		<b>Total</b>		<b>4,422,326</b>	<b>2,792,622</b>	<b>(1,629,704)</b>

## CERTIFICATE OF VESTING OF MATERIALS

This Certificate is for the benefit of City of Edinburgh Council, constituted in terms of the Local Government etc. (Scotland) Act 1994 and having its principal offices at City Chambers, High Street, Edinburgh, Midlothian, EH1 1YJ ("CEC") and relates to the vesting of the Materials and Parts described in Schedule 1 hereto attached.

We Siemens plc of Faraday House, Sir William Siemens Square, Frimley, Camberley, GU16 8QD, England, in consideration of tie's payment to Siemens under the Infraco Contract between tie, Bilfinger Berger Civil UK Limited, Siemens plc and Construcciones Y Auxlliar de Ferrocarriles S.A of the sum of FOURTEEN MILLION, FIVE HUNDRED AND NINTY FIVE THOUSAND AND NINE HUNDERED AND EIGHTY EIGHT POUNDS (£14,595,988) (exclusive of VAT) on or before 22 April 2011 in respect of the Materials and Parts, hereby warrant and undertake to CEC that:-

- 1 the Materials and Parts listed in Schedule 1 are supplied pursuant to Clause 6.1 of the agreed draft Minute of Variation. The Materials and Parts listed in Schedule 2, save for those Materials and Parts listed in Schedule 1, shall be subject to vesting under separate vesting certificates which shall be conditional upon payment pursuant to Clauses 8.1, 8.2 and 8.3 of the agreed draft Minute of Variation;
- 2 nothing remains to be done to the Materials or Parts to complete the same up to the point of their incorporation in (i) the Prioritised Works pursuant to the agreed draft Minute of Variation, and (ii) the On-Street and/or the Off-Street Works (as defined in the agreed draft Minute of Variation);
- 3 the Materials and Parts have been set apart from any third party property and stored at the Siemens warehouse situate at Broxburn (the "Premises") and have been clearly and visibly marked, so far as practicable, in order to identify such Materials and Parts as belonging to CEC ;
- 4 property in the Materials and Parts (including but not limited to supplies received by us from a third party for incorporation in the Materials and Parts) is vested absolutely in us and the Materials and Parts are free from all Security Interests, encumbrances, charges or third party rights of any kind and we are able to pass title to CEC in the Materials and Parts;
- 5 the Materials and Parts are in every respect in accordance with the requirements of the Infraco Contract;
- 6 the Materials and Parts shall at all times after the date of this Certificate be insured by tie by way of the OCIP Insurances taken out and maintained in full force and effect by tie for the required term;
- 7 the Materials and Parts can be inspected at the Premises at any time upon reasonable notice by tie, CEC or by their duly authorised agents; and

EDINBURGH TRAM NETWORK-INFRACO CONTRACT

8 we shall not, except for use on the Infraco Works, remove or cause or permit the Materials or Parts to be moved or removed from the Premises.

We declare that properly in the Materials and Parts shall unconditionally vest in CEC in accordance with the provisions of the agreed draft Minute of Variation upon receipt of the payment referred to above.

We acknowledge our obligations pursuant to Clause 102.2.1 of the Infraco Contract insofar as they relate to the Materials and Parts.

Nothing contained in this Certificate or the Infraco Contract or any payment that may be made to us in respect of the Materials or Parts shall be taken as any approval by the CEC or by their duly authorised agents that the Materials or Parts are in accordance with the Infraco Contract.

We Siemens plc of Faraday House, Sir William Siemens Square, Frimley, Camberley, GU16 8QD, England engaged under the Infraco Contract by the Limited for and on behalf as an operating company of City of Edinburgh Council in consideration of the payment to us of FOURTEEN MILLION, FIVE HUNDRED AND NINETY FIVE THOUSAND AND NINE HUNDRED AND EIGHTY EIGHT POUNDS (£14,595,988) by the warrant that the statements made in provisions 1 to 8 above are true and correct and that all the actions referred to have been taken.

Executed for and on behalf of Siemens PLC

Authorised Signatory

Alfred Brandenburger

Full Name

Dated

15.04.2011

EDINBURGH TRAM NETWORK-INFRACO CONTRACT

**SCHEDULE 1**

**SCHEDULE OF MATERIALS AND PARTS TO VEST ON 22 APRIL 2011**

The Material and Parts are detailed herein in sheet reference '100415\_Inventory List\_Vesting(AEI).xls'.



Schedule 1  
Schedule of Materials and Parts

Siemens Material Location - Inventory

Rev: 15-Apr-2011

Exchange rate

0.8175

Subgroup	Material	Supplier	Current Storage Location	Qty	Unit	Customer Value (EUR)	Customer Value (GBP)	General Remark
DWE	Lifting wheel	Siemens AG	Broxburn, UK	1	unit	58,668	48,144	vested to CEC 22-Apr-2011
DWE	Uncoupled wheel (cable)	Siemens plc (Hessenscheidt)	Broxburn, UK	1	unit	1,477,838	1,204,649	vested to CEC 22-Apr-2011
DWE	Wasting Plant	Smith Bros & Webb Ltd	Edinburgh, UK	1	unit	760,394	620,446	vested to CEC 22-Apr-2011
REL	Composed Pole (H: 372 cms)	Palmer / Siemens plc	Broxburn, UK	41	pcs	760,735	620,755	vested to CEC 22-Apr-2011
REL	Control Wire (1x50mm <sup>2</sup> - 49-483m)	Siemens AG	Broxburn, UK	16,429	m	810,934	666,604	vested to CEC 22-Apr-2011
REL	Control Cable (7x2.5mm <sup>2</sup> - 52,000m)	Siemens plc	Broxburn, UK	32,500	m	102,425	84,550	vested to CEC 22-Apr-2011
REL	Messenger Wire (25.55x1 m)	Siemens AG	Broxburn, UK	14,381	m	408,709	335,721	vested to CEC 22-Apr-2011
REL	MV Swg Incoming + transformer feeding panel	Siemens AG	Broxburn, UK	1	pcs	362,410	296,702	vested to CEC 22-Apr-2011
REL	OCL (National) (Generators)	Siemens AG	Broxburn, UK	84	sets	3,434,281	2,807,325	vested to CEC 22-Apr-2011
REL	OCL (National) Alu Tubes L=9.1m	Siemens plc	Broxburn, UK	6,375	m	309,657	253,872	vested to CEC 22-Apr-2011
REL	OCL (National) Constructions (steel components)	Siemens AG	Broxburn, UK	4,789	pcs	479,161	393,259	vested to CEC 22-Apr-2011
REL	OCL (National) Auxiliary SF6/G	Siemens plc	Broxburn, UK	46	pcs	53,739	44,472	vested to CEC 22-Apr-2011
REL	Power cable DC (230mm <sup>2</sup> - 8,000m+20,000m)	Siemens AG	Broxburn, UK	11,000	m	402,936	330,543	vested to CEC 22-Apr-2011
REL	Power cable DC (400mm <sup>2</sup> - 2,500m)	Siemens plc	Broxburn, UK	2,500	m	52,801	43,352	vested to CEC 22-Apr-2011
REL	Rectifier Transformer	Siemens AG	Broxburn, UK	2	pcs	653,603	534,620	vested to CEC 22-Apr-2011
REL	Stopped Poles (45) pcs	Europoles / Siemens plc	Broxburn, UK	25	pcs	172,465	141,697	vested to CEC 22-Apr-2011
REL	TSS DC Coupled panel (bypass)	Siemens AG	Broxburn, UK	8	pcs	369,353	302,437	vested to CEC 22-Apr-2011
REL	TSS DC Disconnecter panel	Siemens AG	Broxburn, UK	5	pcs	272,731	224,716	vested to CEC 22-Apr-2011
REL	TSS DC REC Incoming & return cubicle	Siemens AG	Broxburn, UK	5	pcs	482,267	395,420	vested to CEC 22-Apr-2011
REL	TSS DC Rectifier	Siemens AG	Broxburn, UK	5	pcs	440,433	360,154	vested to CEC 22-Apr-2011
REL	TSS DC SCD	Siemens AG	Broxburn, UK	3	pcs	751,733	614,545	vested to CEC 22-Apr-2011
REL	TSS DC Track feeder panel cubicle (+3300)	Siemens AG	Broxburn, UK	18	pcs	1,007,868	827,344	vested to CEC 22-Apr-2011
SG	EDU boxes	Siemens plc	Broxburn, UK	220	pcs	135,568	111,650	vested to CEC 22-Apr-2011
SG	WLAN Antennas / Cops	Siemens plc	Broxburn, UK	230	pcs	169,400	139,210	vested to CEC 22-Apr-2011
SG	Interlocking Abgett, New Haven, Queens Terminal	Siemens AG	Broxburn, UK	3	pcs	931,340	764,022	vested to CEC 22-Apr-2011
SG	Interlocking S7 Depot East, Depot West	Siemens AG	Broxburn, UK	2	pcs	545,750	448,150	vested to CEC 22-Apr-2011

Siemens AG  
Mobility Complete Transportation  
Edinburgh Train Network  
April 2011

110415\_110415-UK1\_04-11-2011\_04  
rev: 15-Apr-2011 20:58

CEC02087179\_0028



Schedule 1  
Schedule of Materials and Parts

Subgroup	Material	Supplier	Current Storage Location	Qty	Unit	Customer Value (EUR)	Customer Value (GBP)	General Remark
SIG	Interlocking S7 Haymarket	Siemens AG	Brixham, LK	1	pcs	320,723	270,365	wasted to CEC 22-Apr-2011
SIG	Point blocking circuits (PBC)	Siemens AG	Brixham, LK	50	pcs	as part of the interlockings	as part of the interlockings	wasted to CEC 22-Apr-2011
SIG/COM	Antenna	Siemens plc	Brixham, LK	1	pcs	Included in Radio Substation chargers	Included in Radio Substation chargers	wasted to CEC 22-Apr-2011
SIG/COM	Station Circuit Breakers	Siemens plc	Brixham, LK	7	pcs	Substation chargers	Substation chargers	wasted to CEC 22-Apr-2011
SIG/COM	Coaxial cable	Siemens plc	Brixham, LK	1	lot	50,066	44,118	wasted to CEC 22-Apr-2011
SIG/COM	Depot PAUX (telephones only)	Siemens plc	Brixham, LK	1	lot	Included in PABX	Included in PABX	wasted to CEC 22-Apr-2011
SIG/COM	Fibre Optic Cable	Siemens plc	Brixham, LK	1	lot	41,743	34,125	wasted to CEC 22-Apr-2011
SIG/COM	Multicore signalling cable	Siemens plc	Brixham, LK	1	lot	14,188	11,598	wasted to CEC 22-Apr-2011
SIG/COM	DLE signalling cables	Siemens plc	Brixham, LK	7	lots	17,851	14,892	wasted to CEC 22-Apr-2011
SIG/COM	Point machines	Siemens plc	Brixham, LK	26	pcs	Included in Point Machine costs	Included in Point Machine costs	wasted to CEC 22-Apr-2011
SIG/COM	Point machines	Siemens plc	Brixham, LK	60	pcs	465,456	396,804	wasted to CEC 22-Apr-2011
SIG/COM	Radio base station equipment racks	Siemens plc	Brixham, LK	3	lots	Included in Radio Substation	Included in Radio Substation	wasted to CEC 22-Apr-2011
SIG/COM	Radio base station LFS racks (3 off)	Siemens plc	Brixham, LK	3	pcs	18,106	14,829	wasted to CEC 22-Apr-2011
SIG/COM	Radio system - Hand Helds plus chargers (Kusworth)	Talk Europe Ltd	Brixham, LK	1	lot	974,440	551,157	wasted to CEC 22-Apr-2011
SIG/COM	Substation chargers (8 pcs)	Siemens plc (7 of Brixham, 1 of Gecor Depot Substation)	Brixham, LK	7	pcs	112,250	91,787	wasted to CEC 22-Apr-2011
SIG/COM	Substation comm racks (8 pcs)	Ashby & 1 of Gecor Depot Substation)	Brixham, LK	7	lots	63,420	51,348	wasted to CEC 22-Apr-2011
SIG/COM	Telephone equipment cabinet (26 off)	Siemens plc (4 at Brixham, 19 off Ashby)	Brixham, LK	4	lots	40,381	35,137	wasted to CEC 22-Apr-2011
SIG/COM	Tramstop local power cable	Siemens plc	Brixham, LK	1	lot	24,817	20,370	wasted to CEC 22-Apr-2011
SIG/COM	Tramstop information displays (FID) (42 pcs)	Siemens plc	Brixham, LK	42	pcs	175,817	147,000	wasted to CEC 22-Apr-2011

Materials	£14,565,988	wasted to CEC 22-Apr-2011
other	£5,407,212	unrecovered installation, pre-commissioning, subcontractor site costs, own site costs (supervision, HSE, security, site infrastructure)
<b>Total</b>	<b>£20,003,200</b>	

Siemens plc  
Mossy Common  
Edinburgh  
West Lothian

11/05/2011 10:56:26 AM  
print: 12/14/08: 29/08

CEC02087179\_0029

EDINBURGH TRAM NETWORK-INFRACO CONTRACT

**SCHEDULE 2**  
**SCHEDULE OF ALL MATERIALS AND PARTS**

Schedule 2  
Schedule of Materials and Parts

Siemens Material Location - Inventory

Rev: 15-Apr-2011

Exchange rate:

0.8178

Subgroup	Material	Supplier	Current Storage Location	Qty	Unit	Customer Value (EUR)	Customer Value (GBP)	General Remark
DWE	Access Jacks	Caswell Safety	Bromum, UK	1	set	59,651	48,870	
DWE	Battery Charging Equipment	HAHN+KOLB Werkzeuge GmbH	Siemens store Berlin	1	set	6,587	5,379	consists of 2 pieces
DWE	Scissors and Equipment	HAHN+KOLB Werkzeuge GmbH	Siemens store Berlin	15	pieces	92,515	75,704	set consists of hand vice, tool chain
DWE	Cleaning Machines	HAHN+KOLB Werkzeuge GmbH	Siemens store Berlin	2	units	50,007	40,861	different units
DWE	Compressor station	Kaapor	Bromum, UK	1	set	65,003	52,985	
DWE	Sanitary equipment for emergency	Siemens	Siemens store Berlin	1	set	63,733	52,118	
DWE	Electric Double Grinder	HAHN+KOLB Werkzeuge GmbH	Siemens store Berlin	1	unit	5,998	4,893	
DWE	Electrical Hand Tools	HAHN+KOLB Werkzeuge GmbH	Siemens store Berlin	1	set	31,231	25,500	consists of 13 pieces and accessories
DWE	Electrical measuring device	HAHN+KOLB Werkzeuge GmbH	Siemens store Berlin	1	set	66,404	54,201	consists of 18 pieces
DWE	Folding machine	HAHN+KOLB Werkzeuge GmbH	Siemens store Berlin	1	unit	18,413	15,070	
DWE	Hydraulic ram jacks	Abril rail	Bromum, UK	4	unit	4,853	3,972	
DWE	Hydraulic Workshop Press	HAHN+KOLB Werkzeuge GmbH	Siemens store Berlin	1	unit	14,756	12,071	
DWE	Ladders and Scaffolds	HAHN+KOLB Werkzeuge GmbH	Siemens store Berlin	1	set	37,324	30,512	
DWE	Lifting crane	Siemens AG	Bromum, UK	1	unit	564,490	459,448	valued to CEO 23-Apr-2011
DWE	Manometer	Danfoss & Co. Ltd	Bromum, UK	1	unit	23,553	19,234	
DWE	Manual Lever Sides	HAHN+KOLB Werkzeuge GmbH	Siemens store Berlin	1	unit	1,820	1,495	
DWE	Mechanical Hand Tools	HAHN+KOLB Werkzeuge GmbH	Siemens store Berlin	30	set	29,322	23,900	different sets
DWE	Mechanical Measuring Devices	HAHN+KOLB Werkzeuge GmbH	Siemens store Berlin	1	set	79,306	64,835	consists of 55 pieces and accessories
DWE	Minimax Rail System	Bakemil	Bromum, UK	1	unit	35,769	29,258	
DWE	Minimax Lifting Equipment	HAHN+KOLB Werkzeuge GmbH	Siemens store Berlin	1	set	8,619	7,046	consists of 24 pieces and accessories
DWE	Overhead crane	Steel Crane	Stockport, UK	1	unit	105,636	87,177	
DWE	Pallet stacker	Siemens plc	Bromum, UK	1	unit	20,704	16,926	
DWE	Pallet truck	Platt-Heberlein Verkehrstechnik GmbH & Co. KG	Bromum, UK	3	unit	1,750	1,433	in container #2 with lifting plant
DWE	Pyrol Generator	HAHN+KOLB Werkzeuge GmbH	Siemens store Berlin	2	units	5,540	4,528	
DWE	Portable Lifting Stands	HAHN+KOLB Werkzeuge GmbH	Siemens store Berlin	10	unit	1,845	1,500	
DWE	Safety and site protection equipment	HAHN+KOLB Werkzeuge GmbH	Siemens store Berlin	1	set	103,509	84,518	consists of different equipment

Edinburgh  
Edinburgh Complete Transport  
Edinburgh Team Network  
New Scotland

110415\_inw4009\_List\_Matung.xlsx  
dated: 15/04/2011 10:49

Schedule 2  
Schedule of Materials and Parts

Subgroup	Material	Supplier	Current Storage Location	Qty	Unit	Customer Value (EUK)	Customer Value (GBP)	General Remark
DWE	Scottish Valvewater	Alkerm	Broxburn, UK		4000	752	413	
DWE	Semi Automatic Hack Saw	HAHN+KOLB Werkzeuge GmbH	Siemens store Berlin	1	unit	7,534	4,334	
DWE	Service Vehicle: Dogies and Trains	G. Zwihsch GmbH/Zweilag GmbH	Leichtingen, DE	1	set	1,085,023	1,544,278	consists of 10 different units
DWE	Stop boards: clamps	WZ Elektronik	Broxburn, UK	1	set	2,091	5,707	
DWE	Servo pumps	T&T Pumps	Broxburn, UK	1	set	1,535	1,278	
DWE	Tools for Fibre Glass Works	HAHN+KOLB Werkzeuge GmbH	Siemens store Berlin	1	set	12,335	10,842	
DWE	Tools for Port Machine Maintenance	HAHN+KOLB Werkzeuge GmbH	Siemens store Berlin	1	set	14,103	12,020	consists of different equipment
DWE	Turn Table	Präzisionsbau-Verkehrstechnik GmbH & Co. KG	Präf, Enzenfeld, DE	1	unit	55,770	45,542	
DWE	Underfloor wheel lathe	Siemens plc (Prestonfield)	Broxburn, UK	1	unit	1,472,835	1,204,043	vested to CEC 22-Apr-2011
DWE	Universal Workshop Lathe	HAHN+KOLB Werkzeuge GmbH	Siemens store Berlin	1	set	57,373	49,572	
DWE	Washing Plant	Smith Bros & Webb Ltd.	Edinburgh, UK	1	unit	789,954	629,440	vested to CEC 22-Apr-2011
DWE	Waste containers	HAHN+KOLB Werkzeuge GmbH	Siemens store Berlin	1	set	8,129	6,845	
DWE	Welding Tools	HAHN+KOLB Werkzeuge GmbH	Siemens store Berlin	1	set	25,007	22,000	
DWE	Workshop Furniture	HAHN+KOLB Werkzeuge GmbH	Siemens store Berlin	1	set	87,499	71,506	tool storage, cupboards, safety cabinets, etc.
DWE	Workshop Furniture	Speinn Metall	Broxburn, UK	1	set	58,313	47,671	storage equipment
DWE	Workshop Planing Machine	HAHN+KOLB Werkzeuge GmbH	Siemens store Berlin	1	unit	13,473	11,014	
DWE Total						5,978,744	4,825,982	
REL	Combined Poles (all 372 pcs)	Pfeiffer / Siemens plc	Duisenberg, DE	316	pcs	2,048,359	1,674,452	
REL	Combined Poles (all 372 pcs)	Pfeiffer / Siemens plc	Broxburn, UK	41	pcs	295,755	217,255	vested to CEC 22-Apr-2011
REL	Combined Poles (all 372 pcs)	Pfeiffer / Siemens plc	Orkney 1 (Preston Street)	15	pcs	87,228	70,400	
REL	Contact Wire (150mm <sup>2</sup> ) (49 483m)	Isodrath / Siemens plc	Warrington, GB	81,050	m	1,044,734	854,270	
REL	Contact Wire (150mm <sup>2</sup> ) (49 483m)	Siemens AG	Broxburn, UK	16,428	m	319,544	256,804	vested to CEC 22-Apr-2011
REL	Control Cable (5x2.5mm <sup>2</sup> ) - 700m	Siemens plc	Broxburn, UK	700	m	2,436	1,991	
REL	Control Cable (12x2.5mm <sup>2</sup> and 4x1.5mm <sup>2</sup> ) - 700m	Siemens plc	Broxburn, UK	700	m	7,002	5,724	
REL	Control Cable (3x4mm <sup>2</sup> ) - 1100m	Siemens plc	Broxburn, UK	1,100	m	3,454	2,824	
REL	Control Cable (7x2.5mm <sup>2</sup> ) - 52,000m	Siemens plc	Broxburn, UK	52,000	m	103,428	84,550	vested to CEC 22-Apr-2011
REL	60.0kV Cable N2XCH 3x2.5 REF 5.0 (U) kV	Siemens plc	Broxburn, UK	100	m	852	705	

Siemens plc  
Moby Complex Transportation  
Edinburgh Tram Network  
See Broxburn

1199\_5\_Inventory-List\_Verlog(PE)04.rtf  
print: 15/04/2011 23:01



Schedule 2  
Schedule of Materials and Parts

Subgroup	Material	Supplier	Current Storage Location	Qty	Unit	Customer Value (EUR)	Customer Value (GBP)	General Remark
REL	Medium Voltage Cable (95mm <sup>2</sup> - 600m)	Siemens plc	Broxburn, UK	617 m		7,468	5,103	
REL	Messenger Wire (25.654 m)	Sodran / Siemens plc	Mannheim, DE	11,193 m		314,358	226,340	
REL	Messenger Wire (25.654 m)	Siemens AG	Broxburn, UK	14,961 m		400,329	329,721	vested to CEC 22-Apr-2011
REL	Multifunctional distribution boards	Siemens plc	Broxburn, UK	7 pcs		8,482	7,760	
REL	MV Swa Isolator + transformer feeding panel	Siemens AG	Broxburn, UK	9 pcs		650,400	531,702	vested to CFC 22-Apr-2011
REL	OC Material (General)	Siemens AG	Broxburn, UK	84,076 kg		3,434,381	2,807,525	vested to CEC 22-Apr-2011
REL	OC Material Alu Tubes (ø=8.0m)	Siemens plc	Broxburn, UK	9,376 m		308,857	242,572	vested to CEC 22-Apr-2011
REL	OC Material Constructions (steel components)	Siemens AG	Broxburn, UK	4,308 pcs		476,151	389,253	vested to CEC 22-Apr-2011
REL	OC Material Isolators-SEF-AG	Siemens plc	Broxburn, UK	447 pcs		50,730	41,472	vested to CEC 22-Apr-2011
REL	Power cable DC (150mm <sup>2</sup> - R 000m+20.000m)	Siemens AG	Broxburn, UK	31,825 m		432,656	353,842	vested to CEC 22-Apr-2011
REL	Power cable DC (400mm <sup>2</sup> - 2.200m)	Siemens plc	Broxburn, UK	2,535 m		92,051	75,257	vested to CEC 22-Apr-2011
REL	Rectifier Transformer	Siemens AG	Broxburn, UK	6 pcs		692,800	566,520	vested to CEC 22-Apr-2011
REL	Stepped Poles / 451 pcs.	Euro poles / Siemens plc	Neumarkt, DE	272 pcs		1,041,727	1,587,363	
REL	Stepped Poles / 451 pcs.	Euro poles / Siemens plc	Broxburn, UK	25 pcs		178,420	145,897	vested to CEC 22-Apr-2011
REL	Stepped Poles / 451 pcs.	Euro poles / Siemens plc	Section 7 (PARRANS)	18 pcs		125,497	105,046	
REL	Stepped Poles / 451 pcs.	Euro poles / Siemens plc	Section 8 (Soger Denot)	22 pcs		606,790	496,051	
REL	Stepped Poles / 451 pcs.	Euro poles / Siemens plc	Section 6 (Soger Denot)	37 pcs		394,074	320,800	
REL	TSS DC Coupling panel (bypass)	Siemens AG	Broxburn, UK	6 pcs		330,053	302,437	vested to CEC 22-Apr-2011
REL	TSS DC Disconnecter panel	Siemens AG	Broxburn, UK	6 pcs		372,734	304,710	vested to CEC 22-Apr-2011
REL	TSS DC REC inverter & return cable	Siemens AG	Broxburn, UK	0 pcs		462,267	432,430	vested to CEC 22-Apr-2011
REL	TSS DC Rectifier	Siemens AG	Broxburn, UK	6 pcs		448,333	360,054	vested to CEC 22-Apr-2011
REL	TSS DC SCC	Siemens AG	Broxburn, UK	6 pcs		751,738	614,548	vested to CEC 22-Apr-2011
REL	TSS DC Track feeder and cubicle (4-sect)	Siemens AG	Broxburn, UK	19 pcs		1,087,668	837,344	vested to CEC 22-Apr-2011
REL Total						17,810,615	14,650,178	
S/G	Control control hardware (computer, inverter, switch)	Siemens AG	Broxburn, UK	1 pcs		5,323	4,370	
S/G	Control control hardware (VICOS ATT, VICOS Arch)	Siemens plc	Ashby-de-la-Zouch, UK	1 Set		402,446	328,969	whole system (includes several PCs and other equipment)
S/G	Data Manager	NU	Aachen, DE	1 pcs		5,356	4,370	

Siemens plc  
Veolia Corporate Infrastructure  
Edinburgh, Truro Network  
Local Station

113415\_InventoryList\_WebEngl\_01.xls  
printed: 15/04/2011 23:05

Schedule 2  
Schedule of Materials and Parts

Subgroup	Material	Supplier	Current Storage Location	Qty	Unit	Customer Value (EUR)	Customer Value (GBP)	General Remark
SIG	IMU boxes	Siemens plc	Broxburn, UK	320	pcs	138,398	111,659	wasted to CEC 22-Apr-2011
SIG	IMU100 Antennae / Loops	Siemens plc	Broxburn, UK	230	pcs	159,400	130,310	wasted to CEC 22-Apr-2011
SIG	IMU100 onboard equipment	CAF	Iran, ES	27	one per train	34,778	28,429	
SIG	IMU100 Receiver CPU250 (16 pcs)	Siemens plc	Aztrede-la-Zouche, UK	21	pcs	310,189	253,656	
SIG	IMU100 Receiver CPU250 (25 pcs)	Siemens AG	Braunschweig, DE	24	pcs	484,828	396,782	
SIG	Interlocking Airunit, New Haven, Queen Terminal	Siemens AG	Broxburn, UK	3	pcs	811,342	746,022	wasted to CEC 22-Apr-2011
SIG	Interlocking S7 Depot East, Depot West	Siemens AG	Broxburn, UK	2	pcs	546,752	448,153	wasted to CEC 22-Apr-2011
SIG	Interlocking S7 Haymarket	Siemens AG	Broxburn, UK	1	pcs	330,723	270,566	wasted to CEC 22-Apr-2011
SIG	Multicore signalling cable	Siemens plc		1	lot			
SIG	Parasitic Wide Screen Display 103	Rasco	Gogar Tram Depot, Ed	1	pcs	132,431	108,246	
SIG	Print Blocking circuits (PBD)	Siemens AG	Broxburn, UK	50	pcs			as part of the interlocking as part of the time lockings wasted to CEC 22-Apr-2011
SIG	Print bearing control	Siemens AG		6	pcs	175,033	143,059	
SIG	Radio equipment for 27 trams	CAF	Iran, ES	27	one per train			Included in Radio System Included in Radio System
SIG	TPDS onboard computer	CAF	Iran, ES	27	one per train	508,599	415,780	
SIG	Wifi equipment	IMU	Broxburn, UK	1	set	5,555	4,541	
SIG Total						4,142,116	3,301,386	
SIG/COM	Antenna	Siemens plc	Broxburn, UK	1	pcs			Included in Radio System Included in Radio System wasted to CEC 22-Apr-2011
SIG/COM	Battery Circuit Breakers	Siemens plc	Broxburn, UK Section 6A (Gogar Depot)	7	pcs			Substation chargers Substation chargers wasted to CEC 22-Apr-2011
SIG/COM	Battery Circuit Breakers	Siemens plc	Broxburn, UK	1	pcs			Substation chargers Substation chargers
SIG/COM	Cable for port testers	Siemens plc	Broxburn, UK	1	lot	1,404	1,213	
SIG/COM	Coaxial cable	Siemens plc	Broxburn, UK	1	lot	55,955	44,116	wasted to CEC 22-Apr-2011
SIG/COM	Control centre UPS	Siemens plc	Section 6A (Gogar Depot)	1	pcs	109,495	89,512	
SIG/COM	Depot PABX	Siemens plc	Section 6A (Gogar Depot)	1	lot	92,160	75,341	
SIG/COM	Depot PABX / telephones etc	Siemens plc	Broxburn, UK	1	lot			Included in PABX Included in PABX wasted to CEC 22-Apr-2011
SIG/COM	Fibre Optic Cable	Siemens plc	Broxburn, UK	1	lot	41,743	34,425	wasted to CEC 22-Apr-2011
SIG/COM	Mechanical Points Indicator	IDS	Chersterfield, UK	1	lot	26,389	21,573	
SIG/COM	Multicore signalling cable	Siemens plc	Broxburn, UK	1	lot	14,168	11,669	wasted to CEC 22-Apr-2011

Siemens plc  
Mooney Co release, Transport of  
Edinburgh Tram Network  
Asset Release

11/15 Inventory List - Westinghouse  
page 7 of 22 21:49

Schedule 2  
Schedule of Materials and Parts

Subgroup	Description	Supplier	Current Storage Location	Qty	Unit	Customer Value (EUR)	Customer Value (GBP)	General Remark
SIG.COM	NAL boxes	Siemens plc	Broxburn, UK	1	pcs	1,508	1,233	
SIG.COM	OLE Isolation cabinets	Siemens plc	Broxburn, UK	7	pcs	17,801	14,593	vested to CEC 22-Apr-2011
SIG.COM	Point Heaters	Siemens plc	Broxburn, UK	16	pcs	Included in Point Machine costs	Included in Point Machine costs	vested to CEC 22-Apr-2011
SIG.COM	Point Machines	Siemens plc	Broxburn, UK	60	pcs	435,436	356,844	vested to CEC 22-Apr-2011
SIG.COM	Point Machines (81 pcs)	Siemens plc	Section BA (Cogar Depot)	1	pcs	8,091	6,644	
SIG.COM	Radio base station equipment racks	Siemens plc	Ashby-de-la-Zouch, UK	1	pcs	Included in Radio System	Included in Radio System	
SIG.COM	Radio base station equipment racks	Siemens plc	Broxburn, UK	3	pcs	Included in Radio System	Included in Radio System	vested to CEC 22-Apr-2011
EX.COM	Radio base station UPS racks / 3 off	Siemens plc	Broxburn, UK	3	pcs	15,105	14,801	vested to CEC 22-Apr-2011
SIG.COM	Radio equipment for 27 trams	CAF	Irun, ES	27	pcs	Included in Radio System	Included in Radio System	
SIG.COM	Radio Masts	Tait Europe Ltd	Huntingdon, UK	4	pcs	30,402	24,964	
SIG.COM	Radio system - Hand Helds plus chargers plus	Tait Europe Ltd	Broxburn, UK	1	lot	674,443	551,357	vested to CEC 22-Apr-2011
SIG.COM	Radio system - Control rack	Tait Europe Ltd	Ashby-de-la-Zouch, UK	1	lot	Included in Radio System	Included in Radio System	
SIG.COM	Radio system - 2 hand held radios incl. batteries and	Tait Europe Ltd / CAF	Irun, ES	1	lot	Included in Radio System	Included in Radio System	
SIG.COM	Speaker cable	Siemens plc	Broxburn, UK	1	lot	7,129	5,826	
SIG.COM	Substation chargers (8 pcs)	Siemens plc (7 off Broxburn 1 off Cogar Depot Substation)	Broxburn, UK	7	pcs	112,353	91,767	vested to CEC 22-Apr-2011
SIG.COM	Substation chargers (8 pcs)	Siemens plc (7 off Broxburn 1 off Cogar Depot Substation)	Section BA (Cogar Depot)	1	pcs	16,036	13,110	
SIG.COM	Substation comm. racks (8 pcs)	Ashby & 1 off Cogar Depot Substation)	Broxburn, UK	7	pcs	83,420	51,846	vested to CEC 22-Apr-2011
SIG.COM	Substation comm. racks (8 pcs)	Ashby & 1 off Cogar Depot Substation)	Section BA (Cogar Depot)	1	pcs	9,000	7,407	
SIG.COM	Tramstop equipment cabinet (23 off)	Siemens plc (4 off Broxburn, 19 off Ashby)	Ashby-de-la-Zouch, UK	19	pcs	254,100	186,901	
SIG.COM	Tramstop equipment cabinet (23 off)	Siemens plc (4 off Broxburn, 19 off Ashby)	Broxburn, UK	4	pcs	42,691	35,137	vested to CEC 22-Apr-2011
SIG.COM	Tramstop equipment cable	Siemens plc	Broxburn, UK	1	lot	8,595	7,264	
SIG.COM	Tramstop local power cable	Siemens plc	Broxburn, UK	1	lot	24,217	20,370	vested to CEC 22-Apr-2011
SIG.COM Total						2,384,102	1,697,403	
SIG.SCA	CCTV Equipment - Cameras, Matrix, Storage, etc	Siemens plc	Ashby-de-la-Zouch, UK	1	lot	359,199	291,977	
SIG.SCA	Optical Comm. Equipment, Cabinets (3 pcs)	Siemens plc	Ashby-de-la-Zouch, UK	3	pcs	741,519	609,481	
SIG.SCA	Maintenance Workstation (2 pcs)	Siemens plc	Ashby-de-la-Zouch, UK	2	pcs	24,904	20,405	
SIG.SCA	ODN hardware Equipment	Siemens plc	Ashby-de-la-Zouch, UK	1	lot	786,133	642,664	

Siemens plc  
vested by Company Incorporation  
Exchange: Tram Network  
Asset 50160m

05/01/15 Inventory List - Vostok/UK/uk  
page: 15/34/50/1 23/41



Schedule 2  
Schedule of Materials and Parts

Subgroup	Material	Supplier	Current Storage Location	Qty	Unit	Customer Value (EUR)	Customer Value (GBP)	General Remark
SIG/SCA	Operator Workstations (3 pcs)	Siemens plc	Ashby-de-la-Zouch, UK	3	pcs	49,927	45,811	
SIG/SCA	PA In direction Loop (36 pcs)	Siemens plc	Ashby-de-la-Zouch, UK	36	pcs	Tramstop Equipment	Tramstop Equipment	
SIG/SCA	PA Tramstop Equipment	Siemens plc	Ashby-de-la-Zouch, UK	23	pcs	151,366	129,758	
SIG/SCA	Passenger Help Points (35 pcs)	Siemens		35	pcs	0	0	
SIG/SCA	Passenger information displays (PID) (3 pcs)	Siemens plc	Ashby-de-la-Zouch, UK	3	pcs	12,844	10,500	
SIG/SCA	Passenger information displays (PID) (42 pcs)	Siemens plc	Braxburn, UK	42	pcs	176,817	147,003	ordered in O.S.C. 27-Apr-2011
SIG/SCA	PID pcs prototypes	Siemens plc	Braxburn, UK	2	pcs	2,493	2,038	
SIG/SCA	Speakers (Tramstop platform) (278 pcs)	Siemens		278	pcs	0	0	
SIG/SCA	Speakers (Tramstop shelters) (84 pcs)	Siemens		84	pcs	0	0	
SIG/SCA	Tramstop SCADA Equipment	Siemens plc	Ashby-de-la-Zouch, UK	23	pcs	179,896	147,066	
<b>SIG/SCA Total</b>						<b>2,332,276</b>	<b>1,955,666</b>	
TRW	ACC-drain every 50 meter in embedded track - Pos	BAM Rail	South Yards, Edinburgh, UK	117	pcs	97,191	79,454	
TRW	Ballast Sleepers - Pos. 200170	BAM Rail	South Yards Storage Facility, Edinburgh, UK	260	pcs	142,374	116,261	
TRW	Ballast Sleepers - Pos. 200170	BAM Rail	Section 6 Gogar Depot, Edinburgh, UK	4,389	pcs	594,878	478,138	
TRW	Ballast Sleepers - Pos. 200170	BAM Rail	Busway, Edinburgh, UK	450	pcs	85,731	52,700	
TRW	Ballast Sleepers - Pos. 200170	BAM Rail	Edinburgh Park Bridge site, Edinburgh, UK	4,283	pcs	608,507	456,576	
TRW	Ballast Sleepers - Pos. 200170	BAM Rail	Section 7, Edinburgh, UK	1,441	pcs	207,203	169,388	
TRW	Ballast Sleepers - Pos. 200170	BAM Rail	Gordon Low Storage Facility	90	pcs	13,027	10,650	
TRW	Flat Bottom Rails (standard) - Pos. 200020	BAM Rail	South Yards Storage Facility, Edinburgh, UK	7,894	m	566,866	453,413	
TRW	Flat Bottom Rails (standard) - Pos. 200020	BAM Rail	Section 8 Gogar Depot, Edinburgh, UK	3,009	m	222,606	181,980	
TRW	Flat Bottom Rails (standard) - Pos. 200020	BAM Rail	Edinburgh Park Bridge Site, Edinburgh, UK	3,804	m	698,036	505,734	
TRW	Flat Bottom Rails (standard) - Pos. 200020	BAM Rail	Section 7, Edinburgh, UK currently in transit from BAM	4,698	m	359,341	283,072	
TRW	Flat Bottom Rails (standard) - Pos. 200020	BAM Rail		24,670	m	1,054,787	862,780	
TRW	Grooved Rails - Pos. 200030	BAM Rail	South Yards Storage Facility, Edinburgh, UK	57,070	m	1,038,307	837,494	
TRW	Grooved Rails - Pos. 200030	BAM Rail	Section 8 Gogar Depot, Edinburgh, UK	144	m	16,132	13,188	
TRW	Grooved Rails - Pos. 200030	BAM Rail	Edinburgh Park Bridge site, Edinburgh, UK	612	m	68,562	56,049	
TRW	Grooved Rails - Pos. 200030	BAM Rail	currently in transit from BAM	1,292	m	144,741	118,320	

Siemens plc  
Wendy Campbell Transportation  
Edinburgh Tram Network  
Avalonchem

201415\_Inventory\_List\_Vendor(A3).xls  
dated: 03/14/2011 09:43



Schedule 2  
Schedule of Materials and Parts

Subgroup	Material	Supplier	Current Storage Location	Qty	Unit	Customer Value (EUR)	Customer Value (GBP)	General Remark
TRW	Rail Fastenings for pinh track - Pos. 200140	BAM Rail	South Yards Storage Facility, Edinburgh, UK	6,785,000	pcs	991,531	736,504	
TRW	Rail Fastenings for pinh track - Pos. 200140	BAM Rail	currently in transit (acc. to BAM)	9,701	pcs	1,363,917	1,114,757	
TRW	Small material	BAM Rail	South Yards, Edinburgh, UK	1	ump pump	145,383	119,341	
TRW	Specific Material for Grass Track - Pos. 200250	BAM Rail	South Yards Storage Facility, Edinburgh, UK	2,705	m	1,100,269	901,822	
TRW	Specific Material for Grass Track - Pos. 200250	BAM Rail	Edinburgh Park Bridge site, Edinburgh, UK	244	m	99,335	81,208	
TRW	Specific Material for embedded track - Pos. 200230	BAM Rail	South Yards Storage Facility, Edinburgh, UK	5,479	m	2,342,900	1,915,321	
TRW	Transitional 9 - Pos. 200290	BAM Rail	South Yards Storage Facility, Edinburgh, UK	17	sets	87,951	71,934	
TRW	Transitional 9 - Pos. 200290	BAM Rail	Section 6 Gogar Depot, Edinburgh, UK	8	sets	41,407	33,850	
TRW	Transitional 9 - Pos. 200290	BAM Rail	currently in transit (acc. to BAM)	2	sets	10,352	8,409	
TRW	Turnouts (depot) acc. to alignment drawings - Pos. 2	BAM Rail	Section 8 Gogar Depot, Edinburgh, UK	3	sets	370,039	302,907	
TRW	Turnouts (depot) acc. to alignment drawings - Pos. 2	BAM Rail	currently in transit (acc. to BAM)	8	sets	410,294	340,350	
TRW	Turnouts (main-line) - Pos. 200340	BAM Rail	South Yards Storage Facility, Edinburgh, UK	0	sets	0	0	
TRW	Turnouts (main-line) - Pos. 200340	BAM Rail	currently in transit (acc. to BAM)	2	sets	2,025,088	1,637,525	
TRW Total						15,572,151	12,730,230	
Grand Total						47,934,006	39,210,575	

Total 39,210,575

Materials	£14,696,988	vested to CEC 22-Apr-2011
other	£5,407,212	unrecovered installation, pre-commissioning, subcontractor site costs, own site costs (supervision, HSE, security, site infrastructure)
Total	£20,003,200	

Totals by subgroups:		
DIVE	£ 5,979,744	£4,395,509
REL	£ 17,810,815	£14,560,178
S&G	£4,148,118	£3,331,086
S&G/COM	£2,054,182	£1,867,483
StG/SCN	£2,330,270	£1,965,000
TRW	£ 15,572,151	£12,730,230
Total	£ 47,894,006	£39,210,575





Details OCL Material

Category	BWL	AZV	Description - English	Description - German	Ordered	Unit	Supplier
OCL Material (General)	BWL2097-2A	A2V00001413970	Clevis d=17	Gabel d=17, M8	12	ST	Lufthafen
OCL Material (General)	BWL2104-1	A2V00000205970	Hook end fitting 42, compl.	Hakenknoten 42, kompl.	250	ST	Lufthafen
OCL Material (General)	BWL2104-2	A2V00000205970	Hook end fitting 55	Hakenknoten 55	250	ST	Lufthafen
OCL Material (General)	BWL2114-1 DBB:354655B	A2V00000205150	Eye clamp 55, compl.	Auflagerschelle 55, kompl.	500	ST	Lufthafen
OCL Material (General)	BWL2114-4 DBB:354655A	A2V00000205149	Eye clamp 70, compl.	Auflagerschelle 70, kompl.	160	ST	Lufthafen
OCL Material (General)	BWL2112-1 DBB:354643B	A2V00000205172	Eye clamp 55, compl.	Auflagerschelle 55, kompl.	1.750	ST	Lufthafen
OCL Material (General)	BWL2116-3 DBB:354618A	A2V00000205224	Eye clamp 70/80, compl.	Auflagerschelle 70/80, kompl.	75	ST	Lufthafen
OCL Material (General)	BWL2116-7A	A2V00000205234	Twin drop bracket 42/47.4, compl.	Doppelabzughalter 42/47.4, kompl.	45	ST	Lufthafen
OCL Material (General)	BWL2116-7B	A2V00000205234	Twin drop bracket 55, compl.	Doppelabzughalter 55, kompl.	100	ST	Lufthafen
OCL Material (General)	BWL2118-1 DBB:354662A	A2V00000205266	Orng bracket d2, compl.	Abzughalter d2, kompl.	225	ST	Lufthafen
OCL Material (General)	BWL2118-3 DBB:354662B	A2V00000205267	Orng bracket 55	Abzughalter 55	565	ST	Lufthafen
OCL Material (General)	BWL2118-2A	A2V00000205268	Orng bracket 70/80 → 70, compl.	Abzughalter 70/80 → 70, kompl.	140	ST	Lufthafen
OCL Material (General)	BWL2118-4B	A2V00000205269	Orng bracket 55, compl.	Abzughalter 55, kompl.	27	ST	Lufthafen
OCL Material (General)	BWL2120-7	A2V00000205289	Clav and fitting 70, compl.	Gelenkabel 70, kompl.	90	ST	Lufthafen
OCL Material (General)	BWL2121-5	A2V00000205287	Clav and fitting 55	Gelenkabel 55	502	ST	Lufthafen
OCL Material (General)	BWL2124-3	A2V00000205285	Carrier for swivel bracket for fastening	Gelenkbock für Spindelbefestigung	355	ST	Lufthafen
OCL Material (General)	BWL2124-4 DBB:354650X-01	A2V00000205212	Carrier swivel bracket	Gelenkbock, G-01	391	ST	Lufthafen
OCL Material (General)	BWL2125-1 DBB:354650X-01	A2V00000205202	Carrier swivel bracket	Gelenkbock, G-01	209	ST	Lufthafen
OCL Material (General)	BWL2126-3 DBB:354617X-01	A2V00000205188	Swivel with clavis 18, L=82	Drehgelenk mit Gabel 18, L=82	2.950	ST	Lufthafen
OCL Material (General)	BWL2131-0	A2V00000205061	Pulley 38 with suspension, triple	Scheible 38 mit Aufhängung, drittel	40	ST	Lufthafen
OCL Material (General)	BWL2142-B DBB:354603A	A2V00000205063	Double eye clamp for pull-off	Doppelankerklammer für Zugentlastung	21	ST	Lufthafen
OCL Material (General)	BWL2148-A	A2V00000205095	Hook cap 42, compl.	Hakenkappe 42, kompl.	270	ST	Lufthafen
OCL Material (General)	BWL2148-B	A2V00000205096	Hook cap 55, compl.	Hakenkappe 55, kompl.	330	ST	Lufthafen
OCL Material (General)	BWL2150-0	A2V00000205097	Clasp-open hook clamp for wire 25-50mm²	Hakenklammer für Seil 25-50mm²	310	ST	Lufthafen
OCL Material (General)	BWL2155-2A	A2V00000205052	Clasp-open eye clamp 25-70	Kochlötlösenklammer 25-70	770	ST	Lufthafen
OCL Material (General)	BWL2184-2 DBB:354606X-01	A2V00000205070	End cap 55	Verchlusskappe 55	1.900	ST	Lufthafen
OCL Material (General)	BWL2184-4 DBB:354606X-02	A2V00000205071	End cap 70	Verchlusskappe 70	71	ST	Lufthafen
OCL Material (General)	BWL2184-7 DBB:354606X-07	A2V00000205073	End cap 42	Verchlusskappe 42	260	ST	Lufthafen
OCL Material (General)	BWL2190-0	A2V00000205084	Hook cap 42-80 for U-bolt, M8	Hakenkappe 42-80 für U-Bolten	609	ST	Lufthafen
OCL Material (General)	BWL2201-0	A2V00000205154	Clav and fitting for connection with	Gelenkbock für Verlegetranschutz	1.820	ST	Lufthafen
OCL Material (General)	BWL2206-0	A2V00000205159	Connector sleeve 70	Rohrverlänger 70	100	ST	Lufthafen
OCL Material (General)	BWL2206-1	A2V00000205159	Connector sleeve 55	Rohrverlänger 55	2.080	ST	Lufthafen
OCL Material (General)	BWL2210-0	A2V00000205163	Joint clavis for twin tube	Gelenkbock für Doppeltrohr	210	ST	Lufthafen
OCL Material (General)	BWL2214-0	A2V00000205163	Twin tube clamp 55-70	Doppelrohrschelle 55-70	1.330	ST	Lufthafen
OCL Material (General)	BWL2215-0	A2V00000205164	Twin tube clamp 55-70 with eye	Doppelrohrschelle 55-70 mit Auge	235	ST	Lufthafen
OCL Material (General)	BWL2216-0	A2V00000205165	Twin tube clamp 55-70 with double eye	Doppelrohrschelle 55-70 mit Doppelaugen	102	ST	Lufthafen
OCL Material (General)	BWL2223-1	A2V00000205159	Drop bracket 48-80 3 H=70/90 compl.	Abzughalter 48-80 3 H=70/90 kompl.	5	ST	Lufthafen
OCL Material (General)	BWL2810-0	A2V00000205219	GRP Round rod 26 RAL 1020 L=8m	GRP-Rundstab 26 RAL 1020 L=8m	101	M	Lufthafen
OCL Material (General)	BWL2813-0	A2V00000205220	GRP Round rod 55 RAL 1020 L=8,0m	GRP-Rundstab 55 RAL 1020 L=8,0m	89	M	Lufthafen
OCL Material (General)	BWL2815-0	A2V00000205232	GRP Oval rod 23x33 RAL 1020 L=8,0m	GRP-Ovalstab 23x33 RAL 1020 L=8,0m	1.754	M	Lufthafen
OCL Material (General)	BWL2822-5	A2V00000205235	Fitting 26 with eye 17	Muttern 26 mit Augen 17	30	ST	Lufthafen
OCL Material (General)	BWL2822-7	A2V00000205248	Fitting 26 with clavis d=17	Muttern 26 mit Gabel d=17	30	ST	Lufthafen
OCL Material (General)	BWL2833-0	A2V00000205247	Hook and clamp for GRP rod 23x33, compl.	Hakenklammer für GRP-Rohr 23x33, kompl.	275	ST	Lufthafen
OCL Material (General)	BWL2833-1	A2V00000205248	Swivel cap holder 16R for GRP rod 23x33	Klemmerhalter 16R für GRP-Rohr 23x33	1.835	ST	Lufthafen
OCL Material (General)	BWL3001-2	A2V00000205010	Loop insulator 1.5kV DC	Stromgeleitetrenner 1.5kV DC	1.480	ST	Lufthafen
OCL Material (General)	BWL3121-2C	A2V00000205479	Insulating rod 26 cl. 3c RAL 1020 L=2000	Isolierstab 26 GR 16 RAL 1020 L=2000	26	ST	Lufthafen
OCL Material (General)	BWL3122-5	A2V00000205454	Insulator body 60x60x115 3kV 50kVGN	Isolierkörper 3kV 50kVGN 60x60x115	2.190	ST	Lufthafen
OCL Material (General)	BWL3122-1	A2V00000205456	Insulator body M16xM15 1.5kV DC	Isolierkörper M16xM15 1.5kV DC	22	ST	Lufthafen
OCL Material (General)	BWL3122-1	A2V00000205454	Insulator body for underbrace support	Isolierkörper Form B	18	ST	Lufthafen
OCL Material (General)	BWL3509-0	A2V00000205207	Steady arm L=7/5	Stützarm L=7/5	50	ST	Lufthafen
OCL Material (General)	BWL3514-0	A2V00000205221	Steady arm with GRP rod 23x33 and	Stützarm mit GRP-Rohr 23x33 und	23	ST	Lufthafen
OCL Material (General)	BWL3523-2	A2V00000205238	Birds and pulley suspension with	Seilhalter mit Kunststoffteil 6x6mm	1.140	ST	Lufthafen
OCL Material (General)	BWL3521-0	A2V00000205235	Slack pulley	Scheible mit Seilansatz	290	ST	Lufthafen
OCL Material (General)	BWL3521-3	A2V00000205238	Pulley insulator R+E	Kleinspannungsisolator R+E	12	ST	Lufthafen
OCL Material (General)	BWL3523-0	A2V00000205240	Pulley arm	Abzugarm	92	ST	Lufthafen
OCL Material (General)	BWL3523-0	A2V00000205272	Underbridge and cable support for	Deckenabstärker 1 Tragger bis Teilmtr	12	ST	Lufthafen
OCL Material (General)	BWL3554-6	A2V00000205239	Line hanger 16R for 1.5kV	Feldabstärker 16R für 1.5kV	30	ST	Lufthafen
OCL Material (General)	BWL3575-0	A2V00000205263	Underbridge for underbrace support	Deckenbefestigung für Unterbrücke	12	ST	Lufthafen
OCL Material (General)	BWL4001-4	A2V00000205262	IS-ART: RIG WAGNER 70C16 DU	Anrückschelle WC16 DU	13	ST	Lufthafen
OCL Material (General)	BWL4502-0 DBB:102107X-7	A2V00000205256	Conductor clamping clamp 50-55	Kreuzstromklemme 50-55	8	ST	Lufthafen
OCL Material (General)	BWL4505-3	A2V00000205278	Clamp 12C-15C, TH bronze	Zahnklemme 12C-15C CuSn	1	ST	Lufthafen
OCL Material (General)	BWL4505-5 DBB:074242A	A2V00000205305	Connection clamp 25-70	Verbindungsklemme 25-70	15	ST	Lufthafen
OCL Material (General)	BWL4505-7 DBB:074242A	A2V00000205305	Solid wire clamp 25-50/35-150	Leitpfeilerklemme 25-50/35-150	153	ST	Lufthafen
OCL Material (General)	BWL4517-7L DBB:038905-3A	A2V00000205302	Conduct wire clamp 16R with U-bolt	Feldabstärkerklemme 16R mit U-Bolten	1.953	ST	Lufthafen

Siemens AG  
 Utility Complete Transportation  
 Edinburgh 7 in New York  
 AXN:ELM000

110415\_Inventory List - New York  
 printed: 15/04/2015 16:57



Details OCL Material

Category	BWL	A2V	Description - English	Description - German	Ordered	Unit	Supplier
OCL Material (General)	BWL4517-1M DBB 092006-342	A2V00001187112	Spring wire up M16	Federstahlklemme M16	106	ST	Lufhafen
OCL Material (General)	BWL4524-1B DBB 05321X-72	A2V00001197270	Clamp holder 55 for wire 50-20mm	Klemmenhalter 55 für 50-20mm	10	ST	Lufhafen
OCL Material (General)	BWL4528-1	A2V00001202827	Parallel groove clamp 22	Stegklemme 22	170	ST	Lufhafen
OCL Material (General)	BWL4537-2	A2V00001202823	Parallel groove clamp 25	Stegklemme 25	100	ST	Lufhafen
OCL Material (General)	BWL4578-2	A2V00001202881	Parallel groove clamp 120-185	Stromklemme 120-185	140	ST	Lufhafen
OCL Material (General)	BWL4581-4	A2V00001202891	Parallel groove clamp 150	Stromklemme 1x150	10	ST	Lufhafen
OCL Material (General)	BWL4581-2	A2V00001202883	Conductor clamp 25-150/120-185	Stegklemme 25-180/120-185	730	ST	Lufhafen
OCL Material (General)	BWL4583-0	A2V00001202902	Feeder clamp 120/185-150 for smel	Speiseklemme 120/185-150 bei gethöhe	750	ST	Lufhafen
OCL Material (General)	BWL4504-7	A2V00001202963	Spacer sleeve D18x2x16	Distanzhülse D18x2x16	80	ST	Lufhafen
OCL Material (General)	BWL4812-0	A2V00001202977	Sliding dropper clip for stationary	Geschwindeklammer für Treppel	40	ST	Lufhafen
OCL Material (General)	BWL4520-0 DBB 074212B1	A2V00001203022	Dropper clip 50	Hängeklemme 50	3.500	ST	Lufhafen
OCL Material (General)	BWL4821-3	A2V00001202999	Dropper strap d=12.5	Aufhängebügel d=12.5	80	ST	Lufhafen
OCL Material (General)	BWL4522-4A	A2V00001203023	Groove clamp for wires up to 25mm²	Schlitzklemme für Seile bis 25mm²	80	ST	Lufhafen
OCL Material (General)	BWL4824-4	A2V00001203010	Dropper clip 120	Hängeklemme 120	3.500	ST	Lufhafen
OCL Material (General)	BWL4847-3	A2V00001177800	Our clamp contact wire-stationary wire	Verbindungsklemme Fahrstrom-Treppel	60	ST	Lufhafen
OCL Material (General)	BWL4833-1	A2V00001203044	Wire clip 50	Stegklemme 50	235	ST	Lufhafen
OCL Material (General)	BWL5006-1A	A2V00001206005	Adjusting strap for tensioning device	Einstellband für Radspanner	60	ST	Lufhafen
OCL Material (General)	BWL5079-0C	A2V00001942207	Traction wheel assembly up to 240V	Radspanner bis 240V	90	ST	Lufhafen
OCL Material (General)	BWL5100-0 DBB 08102X-02	A2V00001000334	Weight d=200 h=60 12.5kg	Nachspanngewicht d=200 h=60 12.5kg	50	ST	Lufhafen
OCL Material (General)	BWL5101-0 DBB 08102X-01	A2V00001000333	Weight d=200 h=120 25kg	Nachspanngewicht d=200 h=120 25kg	200	ST	Lufhafen
OCL Material (General)	BWL5102-0 DBB 08102X-04	A2V00001000335	Weight d=300 h=26 12.5kg	Nachspanngewicht d=300 h=26 12.5kg	1.25	ST	Lufhafen
OCL Material (General)	BWL5103-0 DBB 08102X-03	A2V00001000333	Weight d=300 h=33 25kg	Nachspanngewicht d=300 h=33 25kg	1.200	ST	Lufhafen
OCL Material (General)	BWL5154-0 DBB 202212B1800	A2V00001000614	Support bar M2x1800 with washer and	Gewindestange M2x1800 mit Scheibe u	45	ST	Lufhafen
OCL Material (General)	BWL5155-0	A2V00001000615	Support bar M2x2000 with washer and	Gewindestange M2x2000 mit Scheibe u	18	ST	Lufhafen
OCL Material (General)	BWL5167-0	A2V00001000923	Equitatory pulley 75 mm dia with	Scheibe 75 (G)W mit Laschen (S)42mm	90	ST	Lufhafen
OCL Material (General)	BWL5162-1A	A2V00001408858	Pulley 68 with clevis	Scheibe 68 mit Gabel	90	ST	Lufhafen
OCL Material (General)	BWL5167-5	A2V00001177168	Guyd wire with pulley	Anspannseil mit Scheibe	45	ST	Lufhafen
OCL Material (General)	BWL5170-0 DBB 08102X-04	A2V00001000630	Chain 26 for support bar 26	Schelle für Gewindestange 26	60	ST	Lufhafen
OCL Material (General)	BWL5217-5D	A2V00001000800	Section chaulser 1.5 kV DC	Streckkammer 1.5 kV DC	30	ST	Lufhafen
OCL Material (General)	BWL5233-0	A2V00001000219	Setting box AC-120	Stimmkammer AC-120	10	ST	Lufhafen
OCL Material (General)	BWL5245-7A	A2V00001180177	Lightweight section insulator up to 3kV	Leichtbau-Streckstromisoleur bis 3kV DC	13	ST	Lufhafen
OCL Material (General)	BWL5245-1	A2V00001000256	Section insulator 1.5kV with insulating	Streckstromisoleur 1.5kV mit Isolatorkufen	10	ST	Lufhafen
OCL Material (General)	BWL5245-3	A2V00001158723	Section insulator 1.5kV with insulating	Streckstromisoleur 1.5kV mit Isolatorkufen	10	ST	Lufhafen
OCL Material (General)	BWL5245-4D	A2V00001189234	Turbopole M8 L=180-240 for section	Spannschraube M8 L=180-240 für Str	80	ST	Lufhafen
OCL Material (General)	BWL5136-2	A2V00001154400	Disconnecter with 20kV/20kV mediators	Trennschalter mit Verbundisolatoren	12	ST	Lufhafen
OCL Material (General)	BWL5136-4A	A2V00001174023	Disconnecter with composite mediators	Trennschalter mit Verbundisolatoren	15	ST	Lufhafen
OCL Material (General)	BWL5135-7A	A2V00001215585	Support for disconnecter, stainless steel	Konsole für Trennschalter	13	ST	Lufhafen
OCL Material (General)	BWL5135-0	A2V00001186035	Rotation angle sensor until 24V for disconnectors BWL6334	Drehwinkelgeber bis 24V für Trennschalter	6	ST	Lufhafen
OCL Material (General)	BWL6214-7	A2V00001000424	Manual operating mechanism stroke 200mm	Handtriebhub 200mm G-M	24	ST	Lufhafen
OCL Material (General)	BWL6215-0	A2V00001000425	Padlock with 2 keys for manual	Wahlmechanismus mit 2 Schlüsseln für	18	ST	Lufhafen
OCL Material (General)	BWL6231-2 DBB 092912A	A2V00001000640	Groove end fitting 26, compl.	Gelenkstück 26 mit Gabel, kompl.	600	ST	Lufhafen
OCL Material (General)	BWL6225-2	A2V00001000459	Tongue and fitting 26 offset compl.	Gelenkstück 26 mit Auge einseitig, kompl.	23	ST	Lufhafen
OCL Material (General)	BWL6227-2A	A2V00001000636	Locking plate, hlgst	Verriegelungsplatte, St-12n	8	ST	Lufhafen
OCL Material (General)	BWL6231-6	A2V00001000472	Filing for operating linkage	Gelenkstück für Schaltgestänge	25	ST	Lufhafen
OCL Material (General)	BWL6247-6A	A2V00001000731	Guide for operating tube 26	Geleithülse für 26 mit Gewinde M16	180	ST	Lufhafen
OCL Material (General)	BWL6263-7A	A2V00001140217	Volleyed briller with wire 50mm2 for fastening on pole or str	Spannvorrichtung mit Seil 50mm² für	20	ST	Lufhafen
OCL Material (General)	BWL6264-6	A2V00001184630	Voltage limiter element 350V DC technical resistant	Sicherungselement 350V DC	20	ST	Lufhafen
OCL Material (General)	BWL6538-0	A2V00001048000	Surge arrester for DC 1kV 10kA	Überspannungsschleier für DC 1kV 10kA	21	ST	Lufhafen
OCL Material (General)	BWL6730-5	A2V00001000869	Cable strap for 1 cable d=20-24mm	Kabelträger für 1 Kabel D=20-24mm	80	ST	Lufhafen
OCL Material (General)	BWL6730-6	A2V000010008610	Cable strap for 1 cable d=25-30mm	Kabelträger für 1 Kabel D=25-30mm	130	ST	Lufhafen
OCL Material (General)	BWL6731-6	A2V000010008619	Cable strap for 2 cables d=25-30mm and	Kabelträger für 2 Kabel D=25-30mm und	120	ST	Lufhafen
OCL Material (General)	BWL6732-6	A2V000010008617	Cable strap for 4 cables d=25-30mm and	Kabelträger für 4 Kabel D=25-30mm und	130	ST	Lufhafen
OCL Material (General)	BWL6743-0	A2V000010008623	Punch-lock band 19x3.0 (incl. L=30cm)	Spannband 19x3.0 (inkl. L=30cm)	1.500	M	Lufhafen
OCL Material (General)	BWL6748-0	A2V000010008627	Loop 20, Stainless steel	Schleife 20, St-12n	1.500	ST	Lufhafen
OCL Material (General)	BWL6748-0	A2V000010008627	Loop for punch-lock base, stainless	Verzinsl. St-12n Spannb. verstellbar	1.000	ST	Lufhafen
OCL Material (General)	BWL6761-0	A2V000010008642	Punch-lock band for 1-3 cables d=33, polyamide, black	Spannband für 1-3 Kabel D=33	100	ST	Lufhafen
OCL Material (General)	BWL6924-0	A2V000010008630	Soft wire d=3mm flexible	Stahlseil d=3,35mm flexibel	50	M	Lufhafen
OCL Material (General)	BWL7066-2 DBB 203010X-03	A2V000010009194	Wire 10x48, Bronze	Seil 10x48-Br	5.500	M	Lufhafen
OCL Material (General)	BWL7076-0 DBB 203010X-18	A2V000010009203	Wire DIN45136 - B-Cu - 120x336	Seil DIN45136 - B-Cu - 120x336	1.000	M	Lufhafen
OCL Material (General)	BWL7096-0 DBB 203010X-03	A2V000010009210	Steel wire 30mm² d=5,3mm	Gehärtet 30mm² d=5,3mm	1.100	M	Lufhafen
OCL Material (General)	BWL7096-0C	A2V00001153185	Steel wire 30mm² (d=5,3mm), L=7,5m	Stahlseil 30mm² (d=5,3mm), L=7,5m	100	ST	Lufhafen
OCL Material (General)	BWL7097-6	A2V000010009217	Wire 12 EN 12365-4 ex18M-WNSC 1770 B 20	Seil 12 EN 12365-4 ex18M-WNSC 1770 B 20	1.000	M	Lufhafen
OCL Material (General)	BWL7098-2 DBB 203010X-31	A2V000010009234	Stainless steel wire rope d=8mm	Unverzins. St-12n Seil d=8mm	1.100	M	Lufhafen
OCL Material (General)	BWL7098-3	A2V000010009231	Stainless steel wire rope d=8mm	Unverzins. St-12n Seil d=8mm	1.000	M	Lufhafen

Systeme für  
Nutzfahrzeuge Transporthilfe  
Bühnenfahrzeuge  
Antriebsketten

110115\_mercury-List\_Vestergaard  
Printed: 15.03.2017 10:27

Details OCL Material

Category	SWL	A2U	Description - English	Description - German	Ordered	Unit	Supplier
OCL Material (General)	BWL0067-0	AZV00000203736	Synthetic wire (Minarco-wire) 6mm	Kunststoffseil (Minarco) 6mm	200	M	Lufdaten
OCL Material (General)	BWL0068-3	AZV00000203939	Aids for underbridge support	Auflage DIN1443-B46H1X21C19x3-A2	10	ST	Lufdaten
OCL Material (General)	BWL0068-4	AZV00000203940	Support angle	Belebungswinkel	18	ST	Lufdaten
OCL Material (General)	BWL0068-5	AZV00000203911	Fastening plate, GF-LTP, pu	Belebungslageplatte	10	ST	Lufdaten
OCL Material (General)	BWL0068-6	AZV00000203912	'Polytar' web up to 18mm	Seilrolle für 1 Set bis 18mm	16	ST	Lufdaten
OCL Material (General)	RAI F076-7	AZV00000203913	Spacer tube Da-31, D=16.5, L=25.5, polycarbonate	Stützrohr 16,5x25,5	35	ST	Lufdaten
OCL Material (General)	BWL0067-1	AZV00000203927	Termination spring 120 L=1045-1205	Nachspanneder 120 L=1045-1205	15	ST	Lufdaten
OCL Material (General)	BBE0416.141.1 / 8521003AW0	AZV00000211724	Feeder clamps 80-150mm	Seitenschiene 80-150mm	425	ST	RBe 192413
OCL Material (General)	DBB-045442D	AZV00000204948	Parts for pole anchor	Einbauteile für Mastanker	120	ST	Lufdaten
OCL Material (General)	DBB-059691A	AZV00000206199	Claws and fitting 55 comp. gal	Gelenkpaß mit Rommelschuss 55	52	ST	Lufdaten
OCL Material (General)	DBB-06907X-01	AZV00000208242	Rod	Zugstange M16x160-A2	30	ST	Lufdaten
OCL Material (General)	DH1280360	AZV00000210408	Down HPS-1 18016x20-A2	Schutzhülse HPS-1 8016x20-A2	100	ST	Hls 1571851030
OCL Material (General)	DH1280363	AZV00000210404	Down HPS-1 18016x40	Schutzhülse HPS-1 8016x40	900	ST	Hls
OCL Material (General)	DH1280362	AZV000002104374	Down HIT-RE 600-500360	Einbauteil HIT-RE 600-500360	1	ST	Hls
OCL Material (General)	DIN125-A08-4-A2	AZV00000206766	Washer DIN125-AE 4-A2, stainless steel	Scheibe DIN125-AE 4-A2	40	ST	Lufdaten
OCL Material (General)	DIN125-A08-4-A2	AZV00000206769	Washer DIN125-AE 4-A2, stainless steel	Scheibe DIN125-AE 4-A2	40	ST	Lufdaten
OCL Material (General)	DIN125-A10-5-A2	AZV00000206771	Washer DIN125-A10-5-A2	Scheibe DIN125-A10-5-A2	7,333	ST	Lufdaten
OCL Material (General)	DIN125-A13-A2	AZV00000206773	Washer DIN125-A13-A2	Scheibe DIN125-A13-A2	360	ST	Lufdaten
OCL Material (General)	DIN125-A17-A2	AZV00000206775	Washer DIN125-A17-A2	Scheibe DIN125-A17-A2	1,210	ST	Lufdaten
OCL Material (General)	DIN125-A21-A2	AZV00000206778	Washer DIN125-A21-A2	Scheibe DIN125-A21-A2	0,930	ST	Lufdaten
OCL Material (General)	DIN1471-05X030-A2	AZV00000209829	Grooved pin DIN1471-05x30-A2, stainless steel	Kegeleinsatz DIN1471-05x30-A2	52	ST	Lufdaten
OCL Material (General)	DIN1473-05X030-A2	AZV00000209834	Grooved pin DIN1473-05x30-A2	Kegeleinsatz DIN1473-05x30-A2	210	ST	Lufdaten
OCL Material (General)	DIN1481-08X030-A2	AZV00000209856	Pressed steel sleeve DIN1481-08x30-A2	Seamstift DIN1481-08x30-A2	2,100	ST	Lufdaten
OCL Material (General)	DIN1481-08X070-A2	AZV00000209857	Pressed steel sleeve DIN1481-08x70-A2	Seamstift DIN1481-08x70-A2	1,00	ST	Lufdaten
OCL Material (General)	DIN3016-1-A1-20x25-W4	AZV000002155308	Camp DIN 3016-1-A1-20x25-W4	Scheibe DIN 3016-1-A1-20x25-W4	800	ST	HS Betzdorf
OCL Material (General)	DIN3016-1-A1-25x25-W4	AZV000002155308	Camp DIN 3016-1-A1-25x25-W4	Scheibe DIN 3016-1-A1-25x25-W4	55	ST	HS Betzdorf
OCL Material (General)	DIN48235-1-2-160-CL-S	AZV00000208700	Capac. Lug DIN48235-1-2-160-CL-S	Kapazitätslug DIN48235-1-2-160-CL-S	780	ST	Hafenmayer
OCL Material (General)	DIN551-M12X050-A2	AZV00000202062	Stand set screw DIN551-M12x50-A2	Standbohrschraube DIN551-M12x50-A2	2,260	ST	Lufdaten
OCL Material (General)	DIN7549-21-A2	AZV000002112140	Washer DIN7549-21-A2	Scheibe DIN7549-21-A2	800	ST	Leopold 162424
OCL Material (General)	DIN9021-13-A2	AZV00000201056	Washer DIN9021-13-A2, stainless steel	Scheibe DIN9021-13-A2	22	ST	Lufdaten
OCL Material (General)	DIN9021-17-A2	AZV00000202012	Washer DIN9021-17-A2	Scheibe DIN9021-17-A2	30	ST	Lufdaten
OCL Material (General)	DIN931-M08X040-A2-70	AZV00000201018	Hexagon bolt DIN931-M08x040-A2-70, special lubricant on	Sechskantschraube DIN931-M08x040-A2-70	33	ST	Lufdaten
OCL Material (General)	DIN931-M08X130-A2-70	AZV00000201110	Hexagon bolt DIN931-M08x130-A2-70, special lubricant on	Sechskantschraube DIN931-M08x130-A2-70	50	ST	Lufdaten
OCL Material (General)	DIN931-M08X160-A2-70	AZV00000201112	Hexagon bolt DIN931-M08x160-A2-70, special lubricant on	Sechskantschraube DIN931-M08x160-A2-70	120	ST	Lufdaten
OCL Material (General)	DIN931-M10X020-A2-70	AZV00000201150	Hexagon bolt DIN931-M10x20-A2-70	Sechskantschraube DIN931-M10x20-A2-70	133	ST	Lufdaten
OCL Material (General)	DIN931-M10X030-A2-70	AZV00000201154	Hexagon bolt DIN931-M10x30-A2-70, special lubricant on	Sechskantschraube DIN931-M10x30-A2-70	20	ST	Lufdaten
OCL Material (General)	DIN931-M10X035-A2-70	AZV00000201156	Hexagon bolt DIN931-M10x35-A2-70	Sechskantschraube DIN931-M10x35-A2-70	130	ST	Lufdaten
OCL Material (General)	DIN931-M10X040-A2-70	AZV00000201159	Hexagon bolt DIN931-M10x40-A2-70	Sechskantschraube DIN931-M10x40-A2-70	160	ST	Lufdaten
OCL Material (General)	DIN931-M10X050-A2-70	AZV00000201165	Hexagon bolt DIN931-M10x50-A2-70	Sechskantschraube DIN931-M10x50-A2-70	0,350	ST	Lufdaten
OCL Material (General)	DIN931-M12X025-A2-70	AZV00000201174	Hexagon bolt DIN931-M12x25-A2-70	Sechskantschraube DIN931-M12x25-A2-70	20	ST	Lufdaten
OCL Material (General)	DIN931-M12X030-A2-70	AZV00000201176	Hexagon bolt DIN931-M12x30-A2-70, special lubricant on	Sechskantschraube DIN931-M12x30-A2-70	20	ST	Lufdaten
OCL Material (General)	DIN931-M12X040-A2-70	AZV00000201181	Hexagon bolt DIN931-M12x40-A2-70	Sechskantschraube DIN931-M12x40-A2-70	250	ST	Lufdaten
OCL Material (General)	DIN931-M12X045-A2-70	AZV00000201183	Hexagon bolt DIN931-M12x45-A2-70	Sechskantschraube DIN931-M12x45-A2-70	46	ST	Lufdaten
OCL Material (General)	DIN931-M12X050-A2-70	AZV00000201189	Hexagon bolt DIN931-M12x50-A2-70	Sechskantschraube DIN931-M12x50-A2-70	60	ST	Lufdaten
OCL Material (General)	DIN931-M12X060-A2-70	AZV00000201200	Hexagon bolt DIN931-M12x60-A2-70	Sechskantschraube DIN931-M12x60-A2-70	140	ST	Lufdaten
OCL Material (General)	DIN931-M12X075-A2-70	AZV00000201205	Hexagon bolt DIN931-M12x75-A2-70	Sechskantschraube DIN931-M12x75-A2-70	145	ST	Lufdaten
OCL Material (General)	DIN931-M12X085-A2-70	AZV00000201208	Hexagon bolt DIN931-M12x85-A2-70	Sechskantschraube DIN931-M12x85-A2-70	2,400	ST	Lufdaten
OCL Material (General)	DIN931-M12X095-A2-70	AZV00000201209	Hexagon bolt DIN931-M12x95-A2-70, special lubricant on	Sechskantschraube DIN931-M12x95-A2-70	20	ST	Lufdaten
OCL Material (General)	DIN931-M12X100-A2-70	AZV00000201213	Hexagon bolt DIN931-M12x100-A2-70, special lubricant on	Sechskantschraube DIN931-M12x100-A2-70	32	ST	Lufdaten
OCL Material (General)	DIN931-M12X120-A2-70	AZV00000201220	Hexagon bolt DIN931-M12x120-A2-70	Sechskantschraube DIN931-M12x120-A2-70	280	ST	Lufdaten
OCL Material (General)	DIN931-M12X150-A2-70	AZV00000201222	Hexagon bolt DIN931-M12x150-A2-70	Sechskantschraube DIN931-M12x150-A2-70	65	ST	Lufdaten
OCL Material (General)	DIN931-M20X075-A2-70	AZV00000201271	Hexagon bolt DIN931-M20x75-A2-70	Sechskantschraube DIN931-M20x75-A2-70	565	ST	Lufdaten
OCL Material (General)	DIN931-M20X100-A2-70	AZV00000201280	Hexagon bolt DIN931-M20x100-A2-70	Sechskantschraube DIN931-M20x100-A2-70	100	ST	Leopold 192424
OCL Material (General)	DIN934-M08-A4-70	AZV00000201235	Hexagon nut DIN934-M08-A4-70, stainless steel, special lub	Sechskantmutter DIN934-M08-A4-70	20	ST	Lufdaten
OCL Material (General)	DIN934-M08-A4-70	AZV00000201237	Hexagon nut DIN934-M08-A4-70, stainless steel, special lub	Sechskantmutter DIN934-M08-A4-70	30	ST	Lufdaten
OCL Material (General)	DIN934-M10-A4-70	AZV00000201242	Hexagon nut DIN934-M10-A4-70	Sechskantmutter DIN934-M10-A4-70	7,100	ST	Lufdaten
OCL Material (General)	DIN934-M12-A4-70	AZV00000201245	Hexagon nut DIN934-M12-A4-70	Sechskantmutter DIN934-M12-A4-70	510	ST	Lufdaten
OCL Material (General)	DIN934-M16-A4-70	AZV00000201246	Hexagon nut DIN934-M16-A4-70	Sechskantmutter DIN934-M16-A4-70	720	ST	Lufdaten
OCL Material (General)	DIN934-M20-A2-70	AZV00000201252	Hexagon nut DIN934-M20-A2-70	Sechskantmutter DIN934-M20-A2-70	9,300	ST	Lufdaten
OCL Material (General)	DIN963-M16X025-A2	AZV00000201213	Coarse pitch screw DIN963-M16x025-A2	Sechskantschraube DIN963-M16x025-A2	20	ST	Lufdaten
OCL Material (General)	DIN976-EM12X030-A2-70	AZV00000201280	Threaded pin DIN976-EM12x030-A2-70	Gewindestift DIN976-EM12x030-A2-70	40	ST	Lufdaten
OCL Material (General)	DIN976-EM16X030-A2-70	AZV00000201285	Threaded pin DIN976-EM16x030-A2-70	Gewindestift DIN976-EM16x030-A2-70	20	ST	Leopold 192424
OCL Material (General)	DIN976-EM16X040-A2-70	AZV00000201306	Threaded pin DIN976-EM16x040-A2-70	Gewindestift DIN976-EM16x040-A2-70	20	ST	Leopold 192424
OCL Material (General)	DIN976-EM20X030-A2-70	AZV00000201648	Threaded pin DIN976-EM20x030-A2-70	Gewindestift DIN976-EM20x030-A2-70	80	ST	Lufdaten

Siemens AG  
Mobility Components  
Edinburgh from Network  
Axel Gieseler

15441\_mwvener\_Luf\_Vordruck\_A2  
prod. 10/2011 10/21



Details OCL Material

Category	OWL	A2V	Description - English	Description - German	Ordered	Unit	Supplier
OCL Material (General)	DIN 913-BM20x400-A2-70	A2V0001981849	Threaded pin DIN913-BM20x400-A2-70	Gewindeboizen DIN913-BM20x400-A2-70	1.600	ST	Leister 1824424
OCL Material (General)	DIN 913-BM20x490-A2-70	A2V0001971681	Threaded pin DIN913-BM20x490-A2-70	Gewindeboizen DIN913-BM20x490-A2-70	312	ST	Leister 1824424
OCL Material (General)	DIN 913-BM20x550-A2-70	A2V0001149369	Threaded pin DIN913-BM20x550-A2-70	Gewindeboizen DIN913-BM20x550-A2-70	20	ST	Leister 1824424
OCL Material (General)	DSN-01150	A2V0001103553	Earthing rods 1-pole	Erdenführungsstange D. 15 mm	10	ST	Dahj
OCL Material (General)	E596	A2V0001849849	Harfen-mounting rail HS2211-A4-500	Harfen-Montageschiene HS 2211-A4-500	30	ST	Hieffer
OCL Material (General)	IG20XK-2RS	A2V0001133333	Radial spherical plain bearing	Radial-Gelenklager	4	ST	Max Lamb
OCL Material (General)	HEL 111-50160	A2V0001873217	Cable Sa 430x7.0	Kabelader 430x7.0	2.000	ST	Hilfmann IT/COM
OCL Material (General)	HPN-NS5000M120040-A4-50	A2V0001081079	Screw HS5000A1120040-A4-50 incl nut	Haltschraube HS5000A1120040-A4-50	750	ST	HS Bofortg
OCL Material (General)	K274	A2V0001856754	Telescope cap TSW 55-1-G121	Teleskopcap TSW 55-1-G121	620	ST	Loren Scholz
OCL Material (General)	K275	A2V0001856753	Screw protection cap SW 65-1-G 123	Schraubenschutzhülse SW 65-1-G 123	1.020	ST	Loren Scholz
OCL Material (General)	K586	A2V0001354163	UNHB12-1-GALZn	Halb-Boz HB M12x80	80	ST	Möhrer
OCL Material (General)	PARRB-36C	A2V0001288489	schwarz	PARRB-36C	1	M	
OCL Material (General)	PARRB-70C	A2V0001105895	PARRB-70C	PARRB-70C	120	M	Poko 1820436
OCL Material (General)	POE-GPN270-R-12000-3	A2V0001514418	Stripper rectangle 120x60x3	Rechteckstreifen 120x60x3	60	ST	Pfaffenwinn
OCL Material (General)	RS76	A2V0001777797	Harfen screw HS 2215 MS25 4,6 5V	Harfenschraube HS 2215 MS25 4,6 5V	144	ST	Pöhrler
OCL Material (General)	SDP2209	A2V0001270336	spiral rubber-insulated wire	Spiral-Gummiadeflektung	9.100	M	Fryman
OCL Material (General)	INEXZY-O 1x150-0-81KV	A2V0001878102	Cable NEXZY-O 1x150 RM 0.6 (1.2) kV	Kabel NEXZY-O 1x150 RM 0.6 (1.2) kV	900	M	Fryman
OCL Material (General)	RAY-MVTH-35112-1000172-0	A2V0001119166	Shrink hose MVTH-3511-1000172-0	Schrumpfschlauch mit Kleber	310	M	Raytek 500608
OCL Material (General)	RAY-MVTH-35112-1000172-0	A2V0001048771	Shrink hose	Schrumpfschlauch mit Kleber	30	ST	Raytek 500608
OCL Material Air Tubes L=3.0m	3W12161-0 DBB 202016X-01	A2V0001162039	Aluminum tube 28x3.5 DIN EN 755 L=3.0m	Aluminiumrohr 28x3.5 DIN EN 755 L=3.0m	320	M	Weserau 3201837407
OCL Material Air Tubes L=3.0m	3W12165-0 DBB 202016X-00	A2V0001162100	Aluminum tube 42x4.0 DIN EN 755 L=3.0m	Aluminiumrohr 42x4.0 DIN EN 755 L=3.0m	320	M	Weserau 3201837407
OCL Material Air Tubes L=3.0m	3W12167-0 DBB 202016X-03	A2V0001162101	Aluminum tube 35x4.0 DIN EN 755 L=3.0m	Aluminiumrohr 35x4.0 DIN EN 755 L=3.0m	320	M	Weserau 3201837407
OCL Material Air Tubes L=3.0m	3W12170-0 DBB 202016X-04	A2V0001162102	Aluminum tube 70x6.0 DIN EN 755 L=3.0m	Aluminiumrohr 70x6.0 DIN EN 755 L=3.0m	330	M	Weserau 3201837407
OCL Material Constructions (steel components)	D.0215-EL-J4211-0001	A2V0001531702	Connection angle	Anschlusswinkel	27	ST	Südform neu
OCL Material Constructions (steel components)	D.0215-EL-J4211-0002	A2V0001502631	Connection angle track side cabinet	Verbindungs Winkel für	27	ST	Südform neu
OCL Material Constructions (steel components)	D.0215-EL-J4211-0003	A2V0001502629	Connection plate track side cabinet	Verbindungsplatte für	30	ST	Südform neu
OCL Material Constructions (steel components)	D.0215-EL-J4211-0005	A2V0001514812	Hex nut clamp for CRP screw arm	Gelenkhaken für CRP Seitenhaken	1.600	ST	Südform neu
OCL Material Constructions (steel components)	D.0215-EL-J4211-0002	A2V0001833912	Bracket for strain relief (1 cable)	Einbaue für Zuleitendruck (1 Kabel)	71	ST	Südform neu
OCL Material Constructions (steel components)	D.0215-EL-J4211-0003	A2V0001833741	Bracket for strain relief (2 cables)	Einbaue für Zuleitendruck (2 Kabel)	35	ST	Südform neu
OCL Material Constructions (steel components)	D.0215-EL-J4211-0004	A2V0001833742	Cover	Abdeckung	59	ST	Südform neu
OCL Material Constructions (steel components)	D.0215-EL-J4211-0005	A2V0001833743	Flange for cover	Einbaue für Abdeckung	55	ST	Südform neu
OCL Material Constructions (steel components)	D.0215-EL-J4211-0006	A2V0001833911	Cover for spherical plain bearings	Deckel für Gelenklager	9	ST	Südform neu
OCL Material Constructions (steel components)	D.0215-EL-J4211-0007	A2V0001833906	U-bolts MB	Einbauehrube MB	25	ST	Südform neu
OCL Material Constructions (steel components)	D.0215-EL-J4211-0008	A2V0001833709	Suspension strap	Aufhängungsstange	60	ST	Südform neu
OCL Material Constructions (steel components)	D.0215-EL-J4211-0009	A2V0001833745	Strap rectangular for cable guide	Rechteckstange für Kabelführung	58	ST	Südform neu
OCL Material Constructions (steel components)	D.0215-EL-J4211-0011	A2V0001814793	Connection strap for busbar anchor	Verbindungsstange für Mastanker	447	ST	Südform neu
OCL Material Constructions (steel components)	D.0215-EL-J4211-SC02	A2V0001833541	Flange part for pull-off	Einbauehrube für Bogenstütze	17	ST	Südform neu
OCL Material Constructions (steel components)	D.0215-EL-J4211-SC03	A2V0001815458	Tube clamp	Rohrhalter	11	ST	Südform neu
OCL Material Constructions (steel components)	D.0215-EL-J4215-SC01	A2V0001854895	Evo screw M16x240 (steel)	Ölanschraube M16x240 (stahlfertig)	130	ST	Südform neu
OCL Material Constructions (steel components)	D.0215-EL-J4215-SC01	A2V0001814813	Bracket for overhead contact line	Universalleistungsstiel	1.157	ST	Südform neu
OCL Material Constructions (steel components)	D.0215-EL-J4215-SC03	A2V0001814815	Flange part for busbar anchor	Einbauehrube für Mastanker	20	ST	Südform neu
OCL Material Constructions (steel components)	D.0215-EL-J4215-SC04	A2V0001833709	Flange part for surge arrester	Einbauehrube für	20	ST	Südform neu
OCL Material Constructions (steel components)	D.0215-EL-J4215-SC05	A2V0001833709	Flange part for surge arrester	Einbauehrube unter Blitzstiel	6	ST	Südform neu
OCL Material Constructions (steel components)	D.0215-EL-J4215-SC06	A2V0001840000	Flange part for linkage	Einbauehrube für Gelenkführung	25	ST	Südform neu
OCL Material Constructions (steel components)	D.0215-EL-J4215-SC07	A2V0001850006	Weight set 400 kg	Gewichtssatz 400 kg	30	ST	Südform neu
OCL Material Constructions (steel components)	D.0215-EL-J4215-SC08	A2V0001817063	Flange part for linkage in suspension	Einbauehrube unter Gespannleiter	11	ST	Südform neu
OCL Material Constructions (steel components)	D.0215-EL-J4215-SC08	A2V0001817455	Flange part for linkage in suspension	Einbauehrube für Gelenkführung	22	ST	Südform neu
OCL Material Constructions (steel components)	D.0215-EL-J4215-SC10	A2V0001817459	Bracket for loading	Einbauehrube für Verriegelung	0	ST	Südform neu
OCL Material Constructions (steel components)	D.0215-EL-J4215-S011	A2V0001819457	Cover for voltage divider	Schutz für Spannungsteilung	0	ST	Südform neu
OCL Material Constructions (steel components)	D.0215-EL-J4215-S012	A2V0001819398	Flange part for control box	Einbauehrube für Kontrollbox	0	ST	Südform neu
OCL Material Constructions (steel components)	D.0215-EL-J4221-S001	A2V0001822948	Angle 80x80x10	Winkel 80x80x10	16	ST	Südform neu
OCL Material Constructions (steel components)	D.0215-EL-J4221-S002-A	A2V0001840002	Flange angle for pull-offs	Einbauehrube für Bogenstütze	1	ST	Südform neu
OCL Material Constructions (steel components)	D.0215-EL-J4221-S002-B	A2V0001840008	Flange angle for pull-offs	Einbauehrube für Bogenstütze	1	ST	Südform neu
OCL Material Constructions (steel components)	D.0215-EL-J4221-S003	A2V0001885109	Angle 80x80x120	Winkel 80x80x120	6	ST	Südform neu
OCL Material Constructions (steel components)	D.0215-EL-J4221-S004	A2V0001875401	Flange angle for steel termination	Einbauehrube für feste Abhängung	6	ST	Südform neu
OCL Material Constructions (steel components)	D.0215-EL-J4225-S001	A2V0001869476	Clamp angle	Klemmwinkel	25	ST	Südform neu
OCL Material Constructions (steel components)	D.0215-EL-J4225-E001	A2V0001865042	Distance tube for spherical plain	Distanzrohr für Gelenklager	4	ST	Südform neu
OCL Material Constructions (steel components)	D.0215-EL-J4225-E002	A2V0001869303	Distance tube L=60mm for spherical	Distanzrohr L=60mm für Gelenklager	4	ST	Südform neu
OCL Material Constructions (steel components)	D.0215-EL-J4311-S001	A2V0001815276	Bracket 1 for double cantilever	Traverse 1 für Doppelausleger	161	ST	Südform neu
OCL Material Constructions (steel components)	D.0215-EL-J4311-S002	A2V0001814677	Bracket 2 for double cantilever	Traverse 2 für Doppelausleger	54	ST	Südform neu
OCL Material Constructions (steel components)	D.0215-EL-J4311-S003	A2V0001822648	Bracket 3 for double cantilever	Traverse 3 für Doppelausleger	10	ST	Südform neu
OCL Material Constructions (steel components)	D.0215-EL-J4311-S004	A2V0001822649	Bracket 4 for double cantilever	Traverse 4 für Doppelausleger	4	ST	Südform neu
OCL Material Constructions (steel components)	D.0215-EL-J4311-S005	A2V0001822651	Support for cantilever control cabinet	Stütze für Ausleger-Gelenkbox	15	ST	Südform neu
OCL Material Constructions (steel components)	D.0215-EL-J4311-S006	A2V0001822652	Bracket for disconnector	Klamme für Schalter am Stahnrundmast	20	ST	Südform neu

Source: IEC  
Mobility Complete Transformation  
E-energizing Train Network  
And Beyond.

Details OCL Material

Category	BWL	A2V	Description - English	Description - German	Ordered	Unit	Supplier
OCL Material Constructions (steel components)	D 0215-EL-14311-SC07	A2V00001840051	Bracket 3 for double circuit	Traverse 3 für Doppelausleger	4	ST	Südform neu
OCL Material Constructions (steel components)	D 0215-EL-14311-SC08	A2V00001840057	Bracket for manual operating mechanism	Befestigungsst. für Handantrieb	10	ST	Südform neu
OCL Material Constructions (steel components)	D 0215-EL-14311-SC09	A2V00001840106	Support for bipolar disconnector	Konsole für Bipolar-Schalter	3	ST	Südform neu
OCL Material Constructions (steel components)	D 0215-EL-14311-SC10	A2V00001840108	Lever arm	Hebelarm	3	ST	Südform neu
OCL Material Constructions (steel components)	D 0215-EL-14311-SC11	A2V00001876483	Bracket for disconnector in workshop	Konsole für Schalter in Werkstatt	8	ST	Südform neu
OCL Material Constructions (steel components)	D 0215-EL-14311-SC12	A2V00001876484	Bracket for manual operating mechanism workshop	Befestigungsst. für Handantrieb	8	ST	Südform neu
OCL Material linkings SFFAG	BWL0000-1A	A2V00002173126	Composite arculator 3kV DC L=300	Verbundschalter 3kV DC L=300	447	ST	PRISTERER SFFAG 1924611

Scale up to  
 Mobility Complete Transportation  
 Edinburgh Tram Network  
 Steel Erection

110418\_Inv enov\_r\_L3\_MatInj145145  
 print: 15/04/18 11:10:57

CEC02087179\_0043



Bilfinger Berger-Siemens- CAF Consortium

BSC Consortium Office  
9 Lochside Avenue  
Edinburgh Park  
Edinburgh  
EH12 9DJ  
United Kingdom

15 April 2011

To Whom It May Concern

Phone: +44 (0) 131 452 2800  
Fax: +44 (0) 131 452 2900

Bank Details

Account Name :  
Account Number :  
Sort Code :  
Bank Name :  
Bank Address :  
SWIFT Code :  
IBAN :  
  
VAT Registration Nr :



Account Name :  
Account Number :  
Sort Code :  
Bank Name :  
Bank Address :  
SWIFT Code :  
IBAN :  
  
VAT Registration Nr :

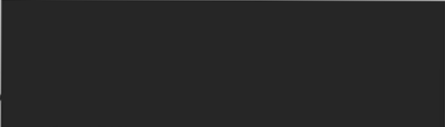

M Foerster  
Project Director  
Bilfinger Berger Siemens CAF Consortium

Bilfinger Berger Civil UK Limited Registered Office: 3<sup>rd</sup> Floor Braywick Gate, Braywick Road, Northfleet, Basildon, SSO 1DA.  
Registered in England & Wales Company No: 2418066  
Siemens plc Registered Office: 81 Vickers Street, Weybridge, Surrey, GU11 3YD Registered in England & Wales Company No: 7270317  
Construcción y Auxiliar de Ferrocarriles S.A. Registered Office: Plaza María Llanos 26, 20200 Barakaldo, Bizkaia, Spain. Registered in Spain. CIF: A-20201020